

# Customer Information Sheet

DRAWING No.: D2XXX-01 / D2XXX-21 SHEET 2 OF 2 IF IN DOUBT - ASK (C) NOT TO SCALE THIRD ANGLE PROJECTION ALL DIMENSIONS IN mm

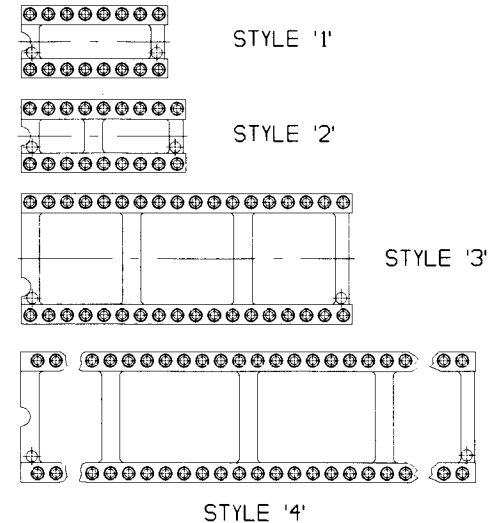
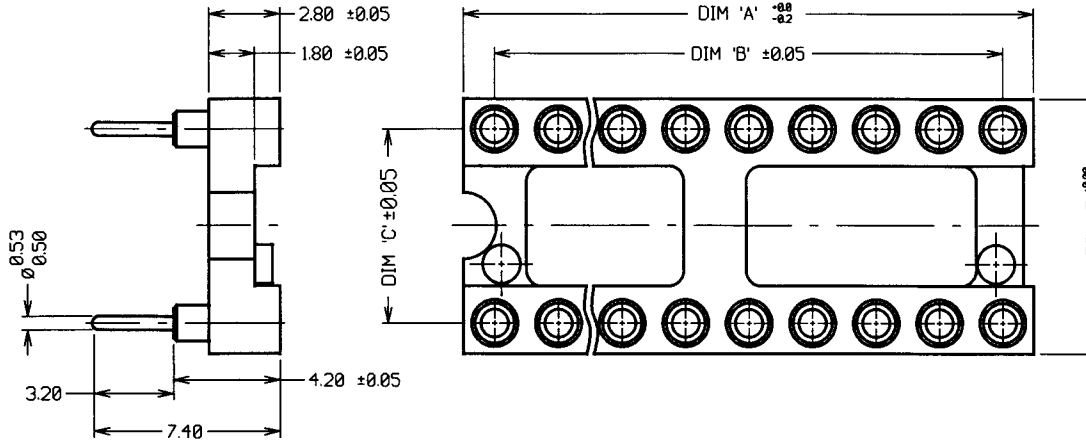

**NOTES:**

- COMPONENTS SUPPLIED IN PLASTIC TUBES 537mm LONG.
- RECOMMENDED MOUNTING HOLE SIZE =  $\varnothing 0.80\text{mm}$

HARWIN PART No.	No. OF WAYS	STYLE	DIM 'A'	DIM 'B'	DIM 'C'	DIM 'D'
D2806-XX	6	1	7.6	5.08	7.62	10.02
D2808-XX	8	1	10.1	7.62	7.62	10.02
D2814-XX	14	1	17.7	15.24	7.62	10.02
D2816-XX	16	1	20.3	17.78	7.62	10.02
D2818-XX	18	2	22.8	20.32	7.62	10.02
D2820-XX	20	2	25.3	22.86	7.62	10.02
D2922-XX	22	2	27.8	25.4	7.62	10.02
D2822-XX	22	2	27.8	25.4	10.16	12.6
D2824-XX	24	2	30.4	27.94	15.24	17.64
D2924-XX	24	2	30.4	27.94	7.62	10.02
D2724-XX	24	2	30.4	27.94	10.16	12.6
D2828-XX	28	2	35.5	33.02	15.24	17.64
D2832-XX	32	2	40.6	38.1	15.24	17.64
D2840-XX	40	3	50.8	48.26	15.24	17.64
D2928-XX	28	3	35.5	33.02	7.62	10.02
D2948-XX	48	3	60.9	58.42	15.24	17.64
D2864-XX	64	4	81.2	78.74	22.86	25.4

**SPECIFICATIONS:**

**MATERIAL:**  
 MOULDING - 30% GLASS FILLED POLYESTER UL94V-0, BLACK  
 SHELL - BRASS  
 CLIP - BERYLLIUM COPPER

**FINISH:**  
 01 - TIN SHELL, GOLD CLIP  
 21 - TIN SHELL, GOLD FLASH

**MECHANICAL:**  
 INITIAL INSERTION FORCE - 3N MAX ( $\varnothing 0.43\text{mm}$   $\varnothing$  GAUGE)  
 INITIAL WITHDRAWAL FORCE - 0.5N MIN ( $\varnothing 0.43\text{mm}$   $\varnothing$  GAUGE)  
 RETENTION FORCE MEASURED WITH A POLISHED STEEL GAUGE  
 DIAMETER  $\varnothing 0.40\text{mm}$  AFTER 3 INSERTIONS OF A PIN WITH  
 A DIAMETER  $\varnothing 0.53\text{mm}$  : 0.14N MIN  
 MECHANICAL LIFE - 100 CYCLES MIN

**ELECTRICAL:**  
 MAXIMUM WORKING CURRENT (1 TERMINAL) - 1 AMP  
 RATED VOLTAGE - 100V RMS / 150V DC  
 CONTACT RESISTANCE - 10 MEGOHMS MAXIMUM  
 INSULATION RESISTANCE - 10000 MEGOHMS  
 DIELECTRIC STRENGTH - 1000V RMS MIN

**TEMPERATURE:**  
 OPERATING TEMPERATURE - -55°C TO 125°C  
 FOR COMPLETE SPECIFICATION, SEE COMPONENT  
 SPECIFICATION C004XX (LATEST ISSUE).

ORDER CODE:

SERIES CODE:  
 (SEE TABLE)

No. OF WAYS:

FINISH:

- 01 - TIN SHELL/GOLD CLIP
- 21 - TIN SHELL/GOLD FLASH CLIP

JAE	14	21.03.02	6560
NAME	ISS.	DATE	C/NO
APPROVED:	<i>[Signature]</i>		
CHECKED:	<i>[Signature]</i>		
DRAWN:	A LIOTTA		
CUSTOMER REF.			
ASSEMBLY DRG:			

**HARWIN**

HARWIN INC  
 U.S.A.  
 TEL: (812) 285 0055  
 FAX: (812) 285 0056

HARWIN PLC  
 U.K.  
 TEL: 023 9237 0451  
 FAX: 023 9231 4590

HARWIN PTE  
 SINGAPORE  
 TEL: 65 7794909  
 FAX: 65 7793868

THIS DRAWING AND ANY  
 INFORMATION OR DESCRIPTIVE  
 MATTER SET OUT HEREON ARE  
 CONFIDENTIAL AND COPYRIGHT  
 PROPERTY OF THE HARWIN  
 GROUP AND MUST NOT BE  
 DISCLOSED, LOANED, COPIED  
 OR USED FOR MANUFACTURING,  
 TENDERING OR FOR ANY  
 OTHER PURPOSE WITHOUT  
 THEIR WRITTEN PERMISSION

**TOLERANCES**  
 X. -  $\pm 1\text{mm}$   
 XX -  $\pm 0.25\text{mm}$   
 XXX -  $\pm 0.10\text{mm}$   
 XXXX -  $\pm 0.05\text{mm}$   
 ANGLES =  $\pm 5^\circ$   
 UNLESS STATED

**MATERIAL:**  
 SEE ABOVE  
**FINISH:**  
 SEE ABOVE  
**S/AREA:**  
 mm<sup>2</sup>

**TITLE:**  
 DIL IC SOCKET  
 OPEN FRAME

**DRAWING NUMBER:**  
 D2XXX-01/D2XXX-21

SHT  
 2  
 OF  
 2