



Have a Question?
Chat with a Product
Information Specialist

What can we help you find?

Products Industries Resources About TE My Account Innovation Support Center

35110 Product Details

Share Print Email



35110

TE Internal Number: 35110

Active

View 3D PDF

Ring and Spade Tongue Terminals

Always EU RoHS/ELV Compliant (Statement of Compliance)

Product Highlights:

- Terminal Shape = Ring Tongue
- Receptacle Style = Straight
- Body Style = PIDG
- Barrel Type = Closed Barrel
- Wire/Cable Type = Regular Wire

View all Features

Quick Links

- Pricing & Availability
- Search for Tooling
- Product Feature Selector
- Contact Us About This Product

Add to My Part List Request Sample Find Similar Products Buy Product

Documentation & Additional Information

Product Drawings:

- TERMINAL, RING TONGUE, PIDG WIRE SIZE: 12-10 AWG (PDF, English)

Catalog Pages/Data Sheets:

- None Available

Product Specifications:

- None Available

Application Specifications:

- Pre-Insulated Diamond Grip (PIDG) Terminals, Splices... (PDF, English)

Instruction Sheets:

- None Available

CAD Files: (CAD Format & Compression Information)

- 2D Drawing (DXF, Version W)
- 3D Model (IGES, Version W)
- 3D Model (STEP, Version W)

List all Documents

Related Products:

- Tooling

Product Features (Please use the Product Drawing for all design activity)

Product Type Features:

- Terminal Shape = Ring Tongue
- Receptacle Style = Straight
- Barrel Type = Closed Barrel
- Wire/Cable Type = Regular Wire
- Insulation = Yes
- Insulation Support = Insulation Support
- Stud Diameter (mm [in]) = 6.73 [0.265]
- Stud Size = 1/4 [M6]
- Shape = RING-041
- Heavy Duty = No
- Finish = Tin
- Color = Yellow

Electrical Characteristics:

- Voltage (VAC) = 300

Termination Features:

- Wire/Cable Size (CMA) = 5,180 - 13,100

Dimensions:

- Insulation Diameter (mm [in]) = 3.81 - 6.35 [.150 - .250]

Body Features:

- Body Style = PIDG
- Wire Range (mm [AWG]) = 3.00-6.00² [12-10]
- Material = Copper
- Tongue Material Thickness (mm [in]) = 1.02 [0.040]
- Insulation Material = Nylon

Contact Features:

- Class = 1 & 2

Industry Standards:

- Government/Industry Qualification = Yes
- Government/Industry Part Number = MS25036-157
- RoHS/ELV Compliance = RoHS compliant, ELV compliant

- Lead Free Solder Processes = Not relevant for lead free process
- RoHS/ELV Compliance History = Always was RoHS compliant

Packaging Features:

- Packaging Method = Loose Piece

Other:

- Brand = AMP

Corporate Information

About TE
Investors

Quick Links

Distributor Inventory
Product Cross Reference

Customer Support

Email or Chat With Us
Find a Phone Number

THIS DRAWING IS UNPUBLISHED. RELEASED FOR PUBLICATION
 © COPYRIGHT - By - ALL RIGHTS RESERVED.

LOC	DIST	REVISIONS					
		P	LTR	DESCRIPTION	DATE	DWN	APVD
G	14		K2	REVISED PER ECO-11-004587	11MAR11	RK	HMR

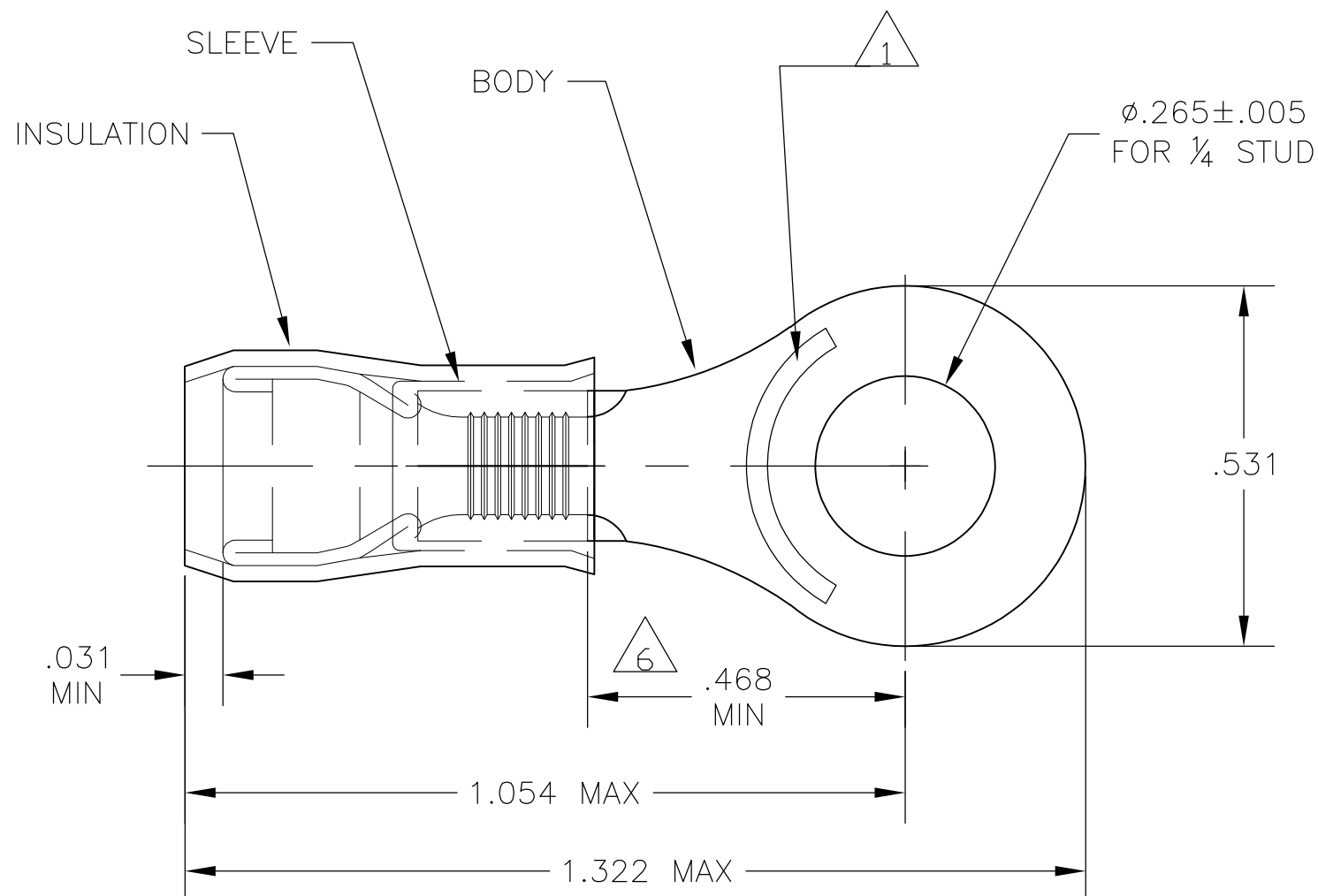

- 1 STAMP "AMP 12-10*" APPROX AS SHOWN
- 2 WIRE INSULATION DIA: .150-.250
- 3 TONGUE MATERIAL THK: .040±.002
- 4 BODY: TIN PLATE .000100 MIN EXT THK PER ASTM B545
- 5 BODY & SLEEVE- CU PER ASTM B152 INSULATION - NYLON, COLOR - YELLOW
- 6 APPLIES FROM EDGE OF METAL WIRE BARREL TO CENTER OF STUD HOLE.
- 7 MEETS MS25036-157, CLASS 1 & 2
- 8 MEETS MS25036-157, CLASS 2

SUPERSEDED BY 8-35110-1	25	LOOSE PIECE, BLS	9-35110-4
SUPERSEDED BY 8-35110-1	5	LOOSE PIECE, BLS	8-35110-5
SUPERSEDED BY 8-35110-1	25	LOOSE PIECE, BAG	8-35110-4
	100	LOOSE PIECE, BOX	8-35110-1
	2500	ON TAPE & REEL	8 2-35110-1
	500	LOOSE PIECE	7 35110
QTY		PACKAGE TYPE	PART NO

CUSTOMER SERVICE SYSTEMS		MAX RECOMMENDED OPERATING TEMPERATURE:		THIS DRAWING IS A CONTROLLED DOCUMENT.		DWN		TE Connectivity		
FOR ADDITIONAL PRODUCT INFORMATION OR COPIES OF DRAWINGS AND TECHNICAL DOCUMENTS		105°C MAX		DIMENSIONS: INCHES		18DEC09				
PRODUCT INFORMATION CENTER 1-800-522-6752		VOLTAGE RATING: 300 VOLT MAX		TOLERANCES UNLESS OTHERWISE SPECIFIED:		18DEC09		SIZE A3 00779		
FOR APPLICATION TOOLING ASSISTANCE CENTER		CIRCULAR MIL AREA: 2.62-6.64mm ² [5,180-13,100] STRANDED OR SOLID		0 PLC ± -		18DEC09				
TOOLING INFORMATION 1-800-722-1111				1 PLC ± -		APVD		RESTRICTED TO -		
FOR ORDER ENTRY 1-800-526-5142				2 PLC ± -		T MICHIELUTTI				
				3 PLC ± .008		T MICHIELUTTI		SHEET 1 OF 1		
				4 PLC ± -		PRODUCT SPEC				
				ANGLES ± -		APPLICATION SPEC		CUSTOMER DRAWING		
				FINISH		WEIGHT				
				- 5		-		REV K2		
				- 4						