

General Purpose Power Entry Module with Fuses



- Rated currents up to 10A
- For one or two fuses
- Optional safety version (A type)
- Optional medical versions (B type) according to IEC/EN 60601-1
- Snap-in versions (S type)

Approvals



ROHS

Technical specifications

| | |
|--|---|
| Maximum continuous operating voltage: | 250VAC, 50/60Hz |
| Operating frequency: | dc to 400Hz |
| Rated currents: | 1 to 10A @ 40°C max. |
| High potential test voltage: | P → PE 2000VAC for 2 sec (standard types) P → PE 2500VAC for 2 sec (B types) P → N 760VAC for 2 sec (standard types) P → N 1700VDC for 2 sec (B types) |
| Protection category: | IP40 according to IEC 60529 |
| Temperature range (operation and storage): | -25°C to +85°C (25/85/21) |
| Design corresponding to: | UL 1283, CSA 22.2 No. 8 1986, IEC/EN 60939 |
| Flammability corresponding to: | UL 94V-2 or better |
| MTBF @ 40°C/230V (Mil-HB-217F): | 2,200,000 hours |
| Fuse holder: | 1 or 2 fuses (Ø5 x 20mm) |

Typical electrical schematic

FN 9260 (B types without Y-capacitors)

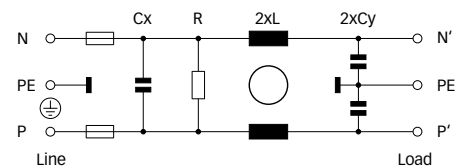

FN 261

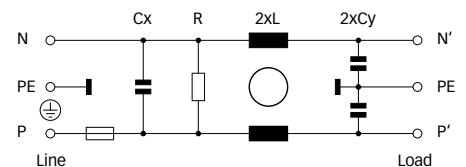

The FN 9260 power entry module combines an IEC inlet, mains filter with excellent filter attenuation and fuses in a small form factor. Choosing FN 9260 product line brings you rapid availability of a standard filter associated with the necessary safety acceptances. Standard IEC connector filters are a practical solution helping you to pass EMI system approval in a short time. A wide selection on amperage ratings, output connections, mounting possibilities and filters for medical applications are designed to offer you the desired solution.

Features and benefits

- Exceptional conducted attenuation performance, based on chokes with high saturation resistance and excellent thermal behavior.
- B types comply with the requirements of IEC/EN 60601-1 for creepage and clearance, leakage current and high potential testing.
- Versions up to 10A are available with fuse holder for one or two fuses.
- Custom-specific versions are available on request.

Typical applications

- Portable electrical and electronic equipment
- Medical equipment
- Small to medium-sized machines and household equipment
- Single-phase power supplies, switch-mode power supplies
- Test and measurement equipment

Filter selection table

| Filter | Rated current @ 40°C (25°C) | Leakage current* @ 230VAC/50Hz | Inductance L | Capacitance | | Resistance R | Input/Output connections | Fuses [Qty] | Weight [g] |
|-------------------|--------------------------------|-----------------------------------|-----------------|-------------|------------|-----------------|-----------------------------|----------------|---------------|
| | [A] | [μA] | [mH] | Cx [μF] | Cy [nF] | [kΩ] | | | |
| FN 9260x-1-06-y | 1 (1.2) | 373 | 5.3 | 0.1 | 2.2 | 1000 | -06 | 2 | 55 |
| FN 9260x-2-06-y | 2 (2.3) | 373 | 2.7 | 0.1 | 2.2 | 1000 | -06 | 2 | 55 |
| FN 9260x-4-06-y | 4 (4.6) | 373 | 1.0 | 0.1 | 2.2 | 1000 | -06 | 2 | 55 |
| FN 9260x-6-06-y | 6 (6.9) | 373 | 0.3 | 0.1 | 2.2 | 1000 | -06 | 2 | 55 |
| FN 9260x-10-06-y | 10 (11.5) | 373 | 0.2 | 0.1 | 2.2 | 1000 | -06 | 2 | 55 |
| FN 9260xA1-1-06-y | 1 (1.2) | 37 | 5.3 | 0.1 | 0.22 | 1000 | -06 | 2 | 55 |
| FN 9260xA-2-06-y | 2 (2.3) | 74 | 2.7 | 0.1 | 0.47 | 1000 | -06 | 2 | 55 |
| FN 9260xA-4-06-y | 4 (4.6) | 74 | 1.0 | 0.1 | 0.47 | 1000 | -06 | 2 | 55 |
| FN 9260xA-6-06-y | 6 (6.9) | 74 | 0.3 | 0.1 | 0.47 | 1000 | -06 | 2 | 55 |
| FN 9260xA-10-06-y | 10 (11.5) | 74 | 0.2 | 0.1 | 0.47 | 1000 | -06 | 2 | 55 |
| FN 9260xB-1-06-y | 1 (1.2) | 2 | 5.3 | 0.1 | | 1000 | -06 | 2 | 55 |
| FN 9260xB-2-06-y | 2 (2.3) | 2 | 2.7 | 0.1 | | 1000 | -06 | 2 | 55 |
| FN 9260xB-4-06-y | 4 (4.6) | 2 | 1.0 | 0.1 | | 1000 | -06 | 2 | 55 |
| FN 9260xB-6-06-y | 6 (6.9) | 2 | 0.3 | 0.1 | | 1000 | -06 | 2 | 55 |
| FN 9260xB-10-06-y | 10 (11.5) | 2 | 0.2 | 0.1 | | 1000 | -06 | 2 | 55 |
| FN 261x-1-06-y | 1 (1.2) | 373 | 5.3 | 0.1 | 2.2 | 1000 | -06 | 1 | 55 |
| FN 261x-2-06-y | 2 (2.3) | 373 | 2.7 | 0.1 | 2.2 | 1000 | -06 | 1 | 55 |
| FN 261x-4-06-y | 4 (4.6) | 373 | 1.0 | 0.1 | 2.2 | 1000 | -06 | 1 | 55 |
| FN 261x-6-06-y | 6 (6.9) | 373 | 0.3 | 0.1 | 2.2 | 1000 | -06 | 1 | 55 |
| FN 261x-10-06-y | 10 (11.5) | 373 | 0.2 | 0.1 | 2.2 | 1000 | -06 | 1 | 55 |

* Maximum leakage under normal operating conditions. Note: if the neutral line is interrupted, worst case leakage could reach twice this level.

Product selector

FN 9260xx-yy-yy-y

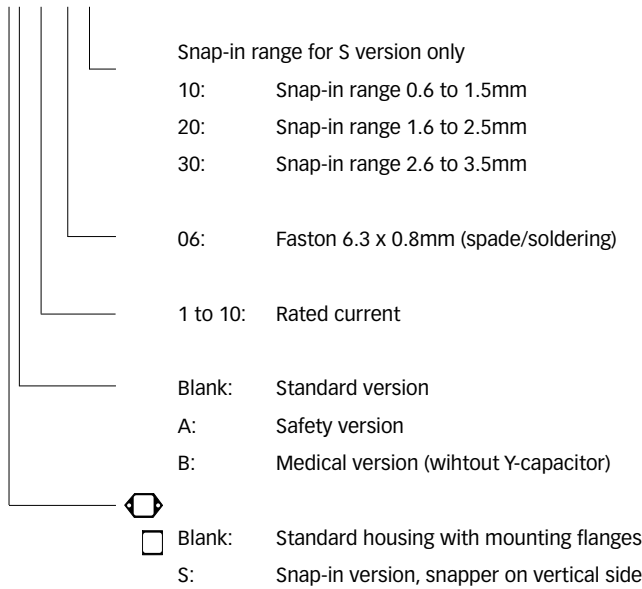

For example: FN 9260-1-06-10, FN 9260SB-10-06-20, FN 261S-6-06-30

Typical filter attenuation

Per CISPR 17; A = 50Ω/50Ω sym; B = 50Ω/50Ω asym; C = 0.1Ω/100Ω sym; D = 100Ω/0.1Ω sym

FN 9260: 1 to 4A types

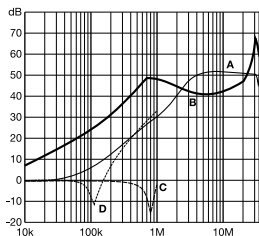

FN 9260: 6 and 10A types

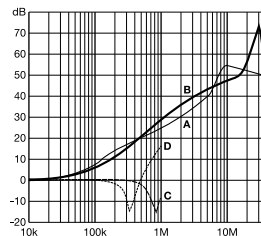

FN 261: 1 to 4A types

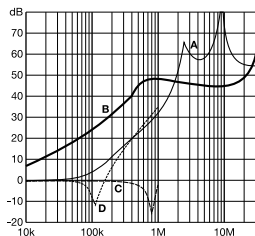

FN 261: 6 and 10A types

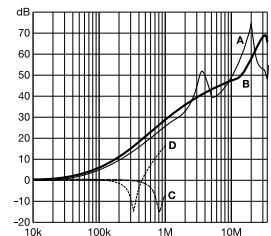

Mechanical data

FN 9260 / FN 261

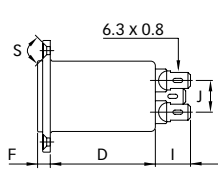
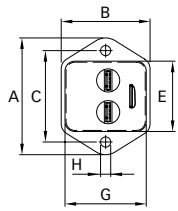

IEC plug type
C14

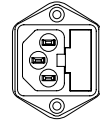

FN 9260S / FN 261S

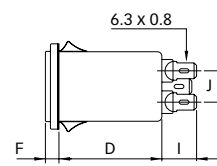
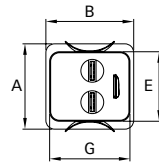

IEC plug type
C14

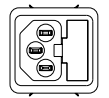

Installation

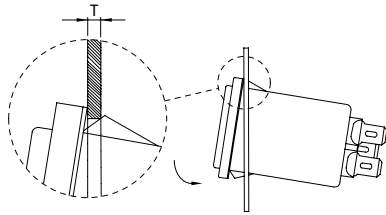

Panel cut out

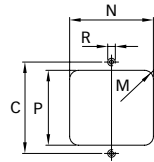

Dimensions

| | FN 9260 FN 261 | FN 9260S FN 261S | Tolerances |
|----|-------------------|---------------------|------------|
| A | 46 | 34 | ±0.3 |
| B | 35 | 35 | ±0.3 |
| C | 36 | | ±0.3 |
| D | 41 | 41 | ±0.3 |
| E | 27.8 | 27.8 | +0.3/-0 |
| F | 5.5 | 5.5 | ±0.3 |
| G | 32 | 32 | +0.3/-0 |
| H | Ø3.2 | | ±0.1 |
| I | 13.8 | 13.8 | |
| J | 12.5 | 12.5 | ±0.3 |
| M | R ≤ 3.5 | R ≤ 3.5 | |
| N | 33 | 33 | +0.3/-0 |
| P | 29 | 29.5 | ±0.3 |
| R | M3 | | |
| S | 90° | | |
| T* | | 0.6 - 1.5 | |
| T* | | 1.6 - 2.5 | |
| T* | | 2.6 - 3.5 | |

* For selecting the panel thickness, please refer to the filter selector table.

All dimensions in mm; 1 inch = 25.4mm

Tolerances according: ISO 2768-m / EN 22768-m

**Headquarters, global innovation
and development center**

Schaffner Group
Nordstrasse 11
4542 Luterbach
Schweiz
T +41 32 681 66 26
F +41 32 681 66 30
info@schaffner.com
www.schaffner.com

To find your local partner within
Schaffner's global network, please go to
www.schaffner.com

© 2012 Schaffner Group
Specifications are subject to change
within notice. The latest version of the
data sheets can be obtained from the
website. All trademarks recognized.

Schaffner is an ISO-registered company.
Its products are designed and
manufactured under the strict quality
and environmental requirements of
the ISO 9001 and ISO 14001 standards.

This document has been carefully
checked. However, Schaffner does not
assume any liability for errors or
inaccuracies.

Sales and application centers

China
Schaffner EMC Ltd. Shanghai
T20-3, No 565 Chuangye Road
Pudong New Area
Shanghai 201201
T +86 21 3813 9500
F +86 21 3813 9501 / 02
cschina@schaffner.com
www.schaffner.com

Finland
Schaffner Oy
Sauvonrinne 19 H
08500 Lohja
T +358 19 35 72 71
F +358 19 32 66 10
finlandsales@schaffner.com

France
Schaffner EMC S.A.S.
112, Quai de Bezons
95103 Argenteuil
T +33 1 34 34 30 60
F +33 1 39 47 02 28
francesales@schaffner.com

Germany
Schaffner Deutschland GmbH
Schoemperlenstrasse 12B
76185 Karlsruhe
T +49 721 56910
F +49 721 569110
germanysales@schaffner.com

Italy
Schaffner EMC S.r.l.
Via Galileo Galilei, 47
20092 Cinisello Balsamo (MI)
T +39 02 66 04 30 45/47
F +39 02 61 23 943
italysales@schaffner.com

Japan
Schaffner EMC K.K.
Mitsui-Seimei Sangenjaya Bldg. 7F
1-32-12, Kamiyuma, Setagaya-ku
Tokyo 154-0011
T +81 3 5712 3650
F +81 3 5712 3651
japansales@schaffner.com
www.schaffner.jp

Singapore
Schaffner EMC Pte Ltd.
Blk 3015A Ubi Road 1
05-09 Kampong Ubi Industrial Estate
T +65 6377 3283
F +65 6377 3281
singaporesales@schaffner.com

Spain
Schaffner EMC España
Calle Caléndula 93
Miniparc III, Edificio E
El Soto de la Moraleja
Alcobendas
28109 Madrid
T +34 618 176 133
spainsales@schaffner.com

Sweden
Schaffner EMC AB
Turebergstorg 1, 6
19147 Sollentuna
T +46 8 5792 1121 / 22
F +46 8 92 96 90
swedensales@schaffner.com

Switzerland
Schaffner EMV AG
Nordstrasse 11
4542 Luterbach
T +41 32 681 66 26
F +41 32 681 66 41
sales@schaffner.ch

Taiwan
Schaffner EMV Ltd.
6th Floor, No 413
Rui Guang Road
Neihu District
Taipei City 114
T +886 2 87525050
F +886 2 87518086
taiwansales@schaffner.com

Thailand
Schaffner EMC Co. Ltd.
Northern Region Industrial Estate
67 Moo 4 Tambon Ban Klang
Amphur Muang P.O. Box 14
Lamphun 51000
T +66 53 58 11 04
F +66 53 58 10 19
thailandsales@schaffner.com

UK
Schaffner Ltd.
5 Ashville Way
Molly Millars Lane
Wokingham
Berkshire RG41 2PL
T +44 118 9770070
F +44 118 9792969
uksales@schaffner.com
www.schaffner.uk.com

USA
Schaffner EMC Inc.
52 Mayfield Avenue
Edison, New Jersey 08837
T +1 732 225 9533
F +1 732 225 4789
usasales@schaffner.com
www.schaffner.com/us