



Quick Reference

Search by part #

Check distributor part inventory

Products

Browse Products

-By Device -

-By Product Line-

-Attachment Methods

-Interface Materials -

-Accessories -

Useful Links

[MSDS Safety Sheets](#)

[How to order?](#)

[Find Sales Rep](#)

[Find Distributor](#)

[Sample Request](#)

[Quote Request](#)

[Catalog Request](#)

[Building a part #](#)

[Part # Cross Ref](#)

For use with TO -220 packages

[Printer friendly version](#)

Part Number - 513002B02500G

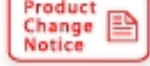

Mechanical Outline Drawing

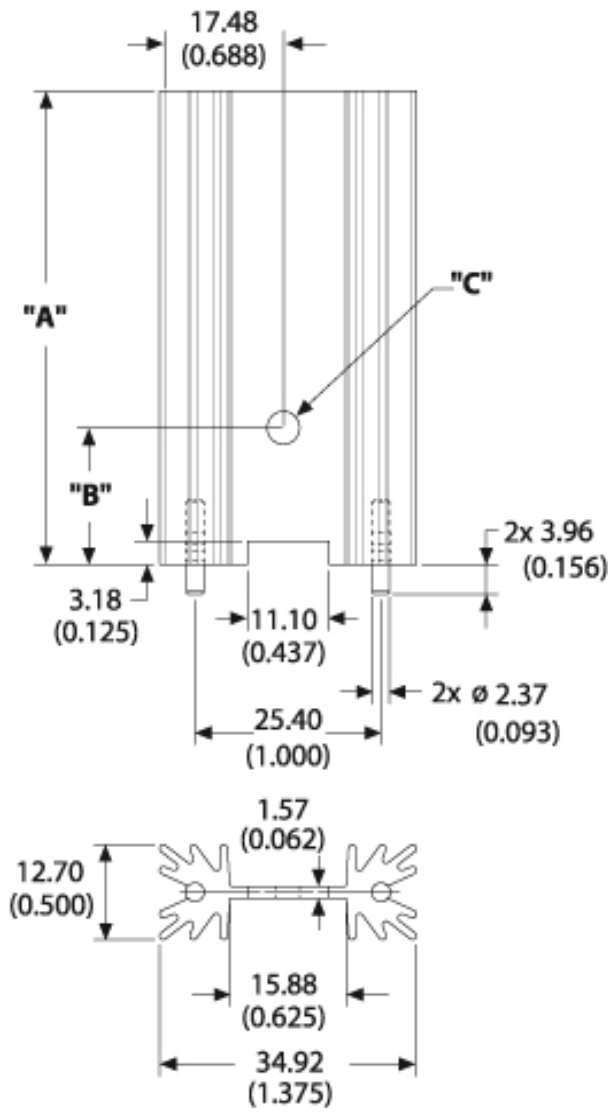

A Dim 25.40
 B Dim 18.29
 C Dim 3.18

Thermal Curves

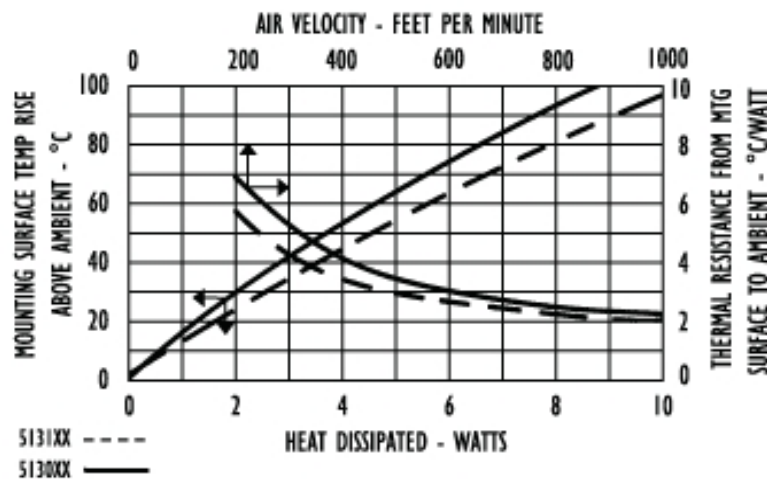

Thermal Resistance	13.40
---------------------------	-------

Thermal resistance value is based on a 75°C rise in natural convection

Product Information

Part #	Description	Finish	Board Mounting
513002B02500G	Extruded heat sink with radial fins with solderable pins	Black Anodize	View Hole Dimensions

This non -electronic component is functionally unaffected by the normal soldering or reflow processes used for semiconductor circuits. The heat resistance time or heat resistance temperature is not applicable for the component.

Not Exactly what you need?

We offer several options for those applications which require a more unique solution. For slight modifications of this part or other attachment options, finishes, and interface materials, contact your [local representative](#). Challenge us with your thermal requirements - we can design custom solutions.