

PAGE 1/2	ISSUE 1422A	SERIES ECO MMCX	PART NUMBER R110A426000
----------	-------------	-----------------	-------------------------

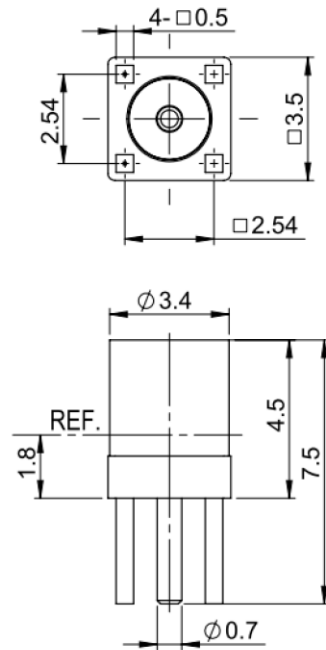

PANEL CUT OUT

mm		
	Maxi	mini
A	0.85	0.75
B	2.56	2.52

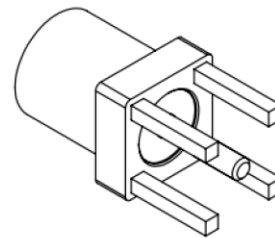
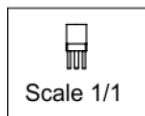

All dimensions are in mm.

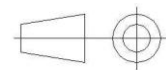

COMPONENTS	MATERIALS	PLATING (μm)
Body	BRASS	GOLD
Center contact	BERYLLIUM COPPER	GOLD
Outer contact		
Insulator	PTFE	
Gasket		
Others parts		
-	-	-
-	-	-

PAGE 2/2	ISSUE 1422A	SERIES ECO MMCX	PART NUMBER R110A426000
----------	--------------------	------------------------	--------------------------------

PACKAGING

Standard	Unit	Other
100	Contact us	Contact us

ELECTRICAL CHARACTERISTICS

Impedance		50	Ω	
Frequency		0-3	GHz	
VSWR	1.35* +	0	x F(GHz) Maxi	
Insertion loss		0.15*	√F(GHz) dB Maxi	
RF leakage	- (NA	- F(GHz) dB Maxi	
Voltage rating		170	Veff Maxi	
Dielectric withstanding voltage		250	Veff mini	
Insulation resistance		1000	MΩ mini	

MECHANICAL CHARACTERISTICS

Center contact retention				
Axial force – Mating End		10	N mini	
Axial force – Opposite end		10	N mini	
Torque		NA	N.cm mini	
Recommended torque				
Mating		NA	N.cm	
Panel nut		NA	N.cm	
Mating life		100	Cycles mini	
Weight		0.27	g	

ENVIRONMENTAL

Operating temperature	-40/+85	°C
Hermetic seal	NA	Atm.cm3/s
Panel leakage	NA	

SPECIFICATION

OTHER CHARACTERISTICS

Assembly instruction:

Others:

***COAXIAL TRANSMISSION LINE ONLY**