

THIS DRAWING IS UNPUBLISHED. RELEASED FOR PUBLICATION
 © COPYRIGHT BY TYCO ELECTRONICS CORPORATION. ALL RIGHTS RESERVED.

LOC	DIST	REVISIONS			
P	LTR	DESCRIPTION	DATE	DWN	APVD
AA	00	S	ECO-06-009878	27JULY06	LAM AWF

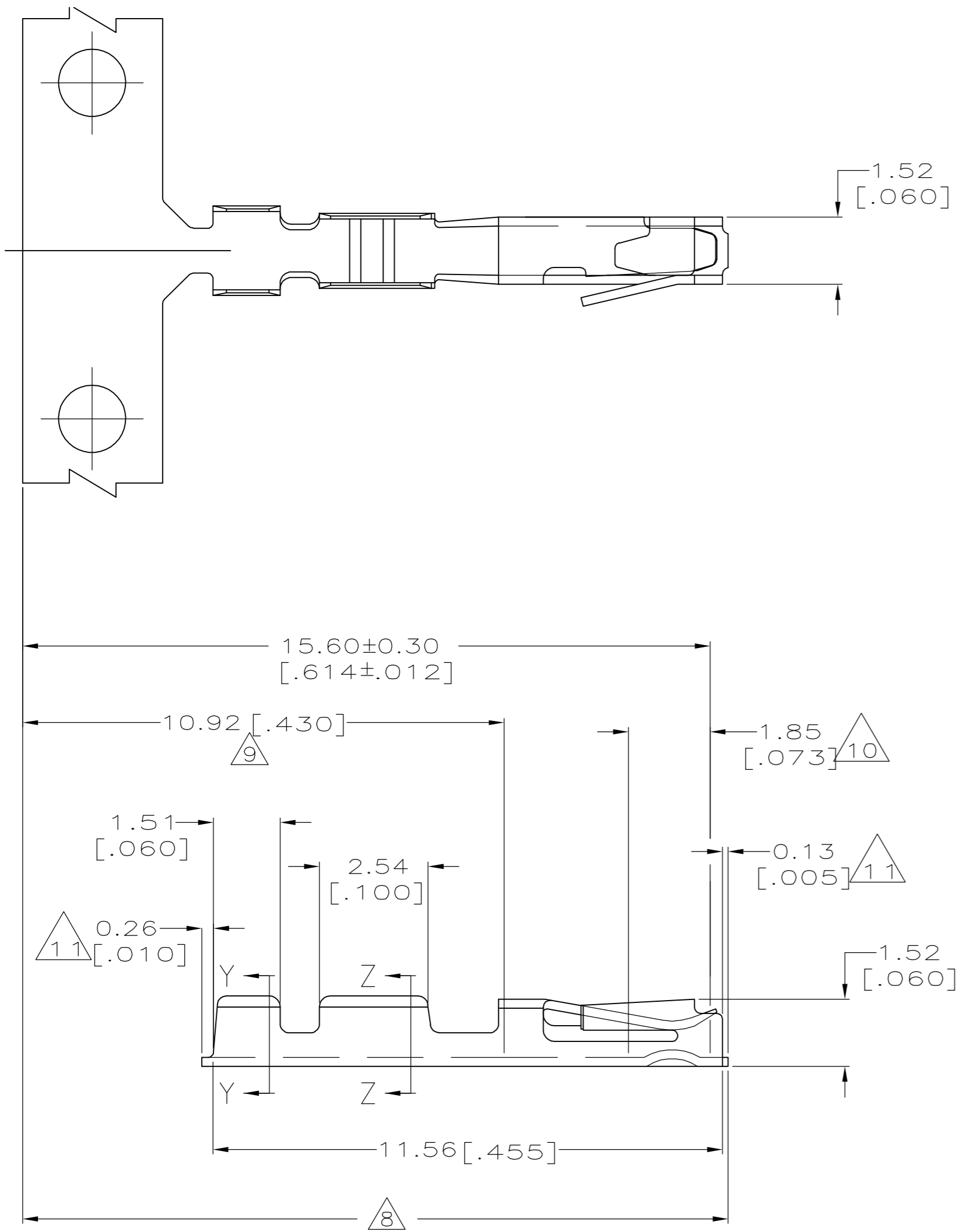

1. WIRE RANGE 22-26 AWG.
2. INSULATION RANGE 0.91-1.37 [.036-.054] DIA.
- 3 0.00254 [.000100] MIN TIN-LEAD OVER 0.000762 [.000030] MIN NICKEL.
- 4 PREPLATED 0.00127 [.000050] MIN TIN-LEAD IN ZONES I & II, 0.000762 [.000030] MIN GOLD OVER 0.000762 [.000030] MIN NICKEL INLAY IN ZONE III.
- 5 PREPLATED 0.00127 [.000050] MIN TIN-LEAD IN ZONES I & II, 0.00127 [.000050] MIN GOLD OVER 0.000762 [.000030] MIN NICKEL INLAY IN ZONE III.
- 6 PHOSPHOR BRONZE.
- 7 PREPLATED 0.00127 [.000050] MIN TIN IN ZONES I & II, 0.00127 [.000050] MIN GOLD OVER 0.000762 [.000030] MIN NICKEL INLAY IN ZONE III.
- 8 ZONE I (OUTSIDE SURFACES).
- 9 ZONE II (INSIDE SURFACES).
- 10 ZONE III (INSIDE SURFACES).
- 11 MAXIMUM CUTOFF.

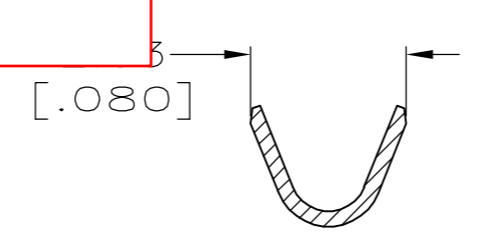
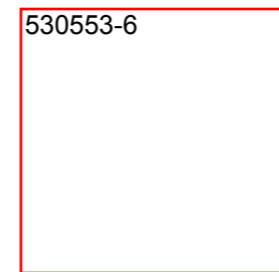

SECTION Y-Y

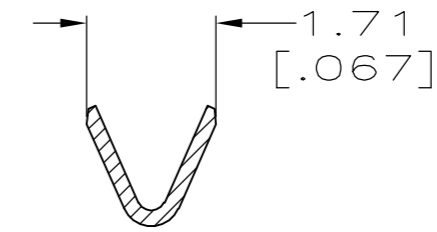

SECTION Z-Z

	FINISH	LOOSE PIECE PART NO	STRIP PART NO
	7	-	9-530553-0
OBSOLETE		530553-9	530553-8
	5	530553-7	530553-6
OBSOLETE	4	530553-5	530553-4
	3	530553-3	530553-2

THIS DRAWING IS A CONTROLLED DOCUMENT.		DWN B. HAYMAKER 08JAN99	Tyco Electronics Corporation Harrisburg, PA 17105-3608	
DIMENSIONS: mm		CHK S. BOLASH 08JAN99	NAME S. BOLASH 08JAN99	
TOLERANCES UNLESS OTHERWISE SPECIFIED: 0 PLC ± - 1 PLC ± - 2 PLC ± - 3 PLC ± 0.13[.005] 4 PLC ± - ANGLES ± -		APVD S. BOLASH 08JAN99	PRODUCT SPEC 108-25031	
MATERIAL 6		FINISH 3 4 5 7	APPLICATION SPEC 114-25021	SIZE A2
		WEIGHT -	CAGE CODE 00779	DRAWING NO C=530553
		CUSTOMER DRAWING	SCALE 4:1	SHEET 1 of 1
			RESTRICTED TO -	REV S