

## 1-332056-0 Product Details

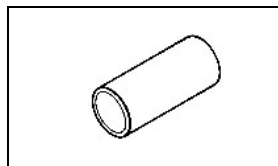

**1-332056-0**

TE Internal Number: 1-332056-0



Active

### Multiple Coaxial Contacts (COAXICON)



Always EU RoHS/ELV Compliant (Statement of Compliance)

#### Product Highlights:

- Accessory
- Accessory Type = Ferrule
- Cable Type = Belden 9221, RG 161, RG 174, RG 179, RG 179A, RG 179B, RG 187, RG 187A, RG 188, RG 188A, RG 316
- Wire Diameter = 2.84 mm
- Ferrule Diameter = 2.84 mm

### Documentation & Additional Information

#### Product Drawings:

- [ferrule](#) (PDF, English)

#### Catalog Pages/Data Sheets:

- [COAXICON Contacts](#) (PDF, English)
- [Coaxial Contacts](#) (PDF, English)
- [M\\_SERIES\\_PIN\\_AND\\_SOCKET\\_CONNECTORS](#) (PDF, English)
- [AMP Circular Connectors for Commercial Signal & Powe...](#) (PDF, English)

#### Product Specifications:

- [Subminiature COAXICON Contacts](#) (PDF, English)

#### Application Specifications:

- None Available

#### Instruction Sheets:

- [Series SMC Dual Crimp Type COAXICON Connectors](#) (PDF, English)

#### CAD Files:

- None Available

#### Related Products:

- [Tooling](#)

### Product Features (Please use the Product Drawing for all design activity)

#### Product Type Features:

- [Product Type](#) = Accessory
- Accessory Type = Ferrule
- [Cable Type](#) = Belden 9221, RG 161, RG 174, RG 179, RG 179A, RG 179B, RG 187, RG 187A, RG 188, RG 188A, RG 316

#### Body Features:

- Wire Diameter (mm [in]) = 2.84 [0.112]
- Ferrule Diameter (mm [in]) = 2.84 [0.112]
- Ferrule Material = Copper
- Ferrule Plating = Tin
- Used With = CPC Connectors

#### Industry Standards:

- [RoHS/ELV Compliance](#) = RoHS compliant, ELV compliant
- [Lead Free Solder Processes](#) = Not relevant for lead free process
- RoHS/ELV Compliance History = Always was RoHS compliant

#### Other:

- Brand = AMP
- Comment = Extraction Tool No. 305183

LOC	AJ	DIST	16
-----	----	------	----

© COPYRIGHT 1965 BY AMP INCORPORATED, HARRISBURG, PA. ALL INTERNATIONAL RIGHTS RESERVED. AMP PRODUCTS MAY BE COVERED BY U.S. AND FOREIGN PATENTS AND/OR PATENTS PENDING.

REVISIONS					
P	F	LTR	DESCRIPTION	DATE	APPROVED
	✓	F	REDRAWN	C83-769	1-4-81 ms/DH

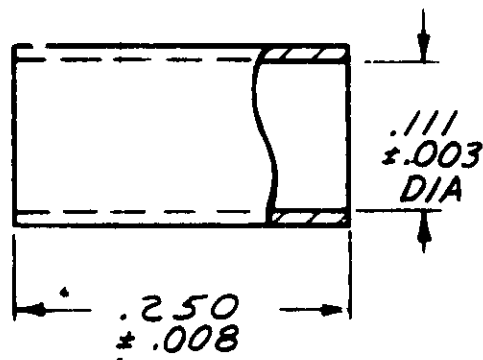

- ① COPPER PER ASTM-B-152.  
② TIN PL PER MIL-T-10727

PART NO

LESS OTHERWISE  
SPECIFIED DIMENSIONS  
ARE IN INCHES.  
TOLERANCES ON:  
DIMENSIONS ± \_\_\_\_\_  
ANGLES ± \_\_\_\_\_

**MATERIAL**



## FINISH



**CONTRACT NO**

DR ~~1~~ ~~5~~ ~~6~~ 4-4-84

CHN 4/6/84

202/1004

10/10/88

**DSGN APPD**

**OTHER APPD**

**AMP**

**AMP INCORPORATED**  
**Harrisburg, Pa. 17105**

NAME \_\_\_\_\_

FERRULE

**SIZE**

# A

FSCM NO

**00779**

**DRAWING NO**

1-332056-0

SCALE *NTS*

SHEET \_\_\_\_\_