

**D09S33E4GV00LF - D-Subminiature Delta D : Signal
9 way Socket Right Angle
Solder US standard, 200
cycles, Harpoons + Female
Screw UNC 4 - 40 + Elec cont.,
1.6 mm PCB thickness**

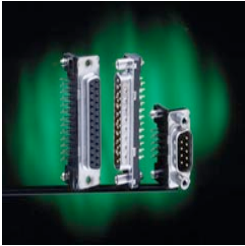

www.fci.com

Mating Half

DE09P064TXLF

865609PLTXLF

Specifications

General	
Contact type	Signal
Gender	Socket
Number of contacts (Total)	9
Orientation	Right Angle
Product Type	Connector
Termination Style	Solder
Dimensional	
Size (Shell)	E
Thickness (Board)	1.6 mm
Electrical	
Current rating	5A Per contact
Resistance (Contact)	< 10 milli-ohms
Voltage rating	300V rms at 50 Hz
Voltage rating (DWV - Dielectric withstanding)	1000V rms
Mechanical	
Durability (Plating - Mating cycles)	Std Class (>200 Mating Cycles)
Extraction force (Mating part)	0.3N min. Per contact
Insertion force (Mating part)	5N max. Per contact
Mounting	
Attachment	Board
Mounting accessory	Harpoons + Female Screw UNC 4-40 + Electrical continuity
Termination	US standard
Physical	

Plating (Contact)	Gold over Nickel
Plating (Shell)	Bright Pure Tin over Nickel
Plating (Termination)	Matte Tin over Nickel
Temperature (Operating - range)	-55°C to +125°C
Approvals / Certifications	
Approvals / Certifications	Recognized File E 118235 (R)
Other Features	
Most Popular Configuration	Yes

Tous droits strictement réservés. Reproduction ou communication à des tiers interdites sans autorisation écrite de la propriété de FCI. Droits de reproduction FCI.

FCI

All rights strictly reserved. Reproduction or communication to any third party in any form without the written authority from the proprietor. Property of FCI. Copyright FCI.

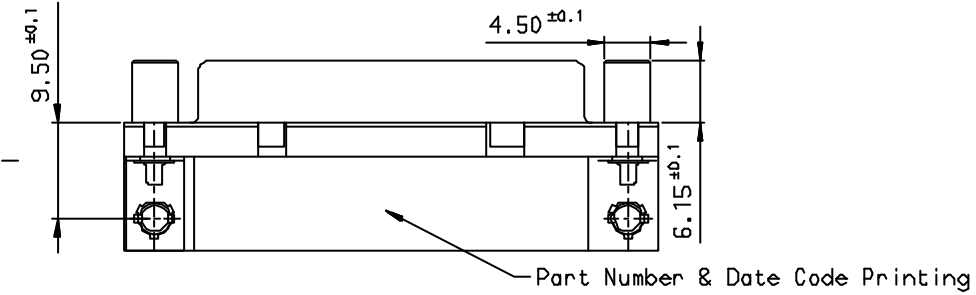
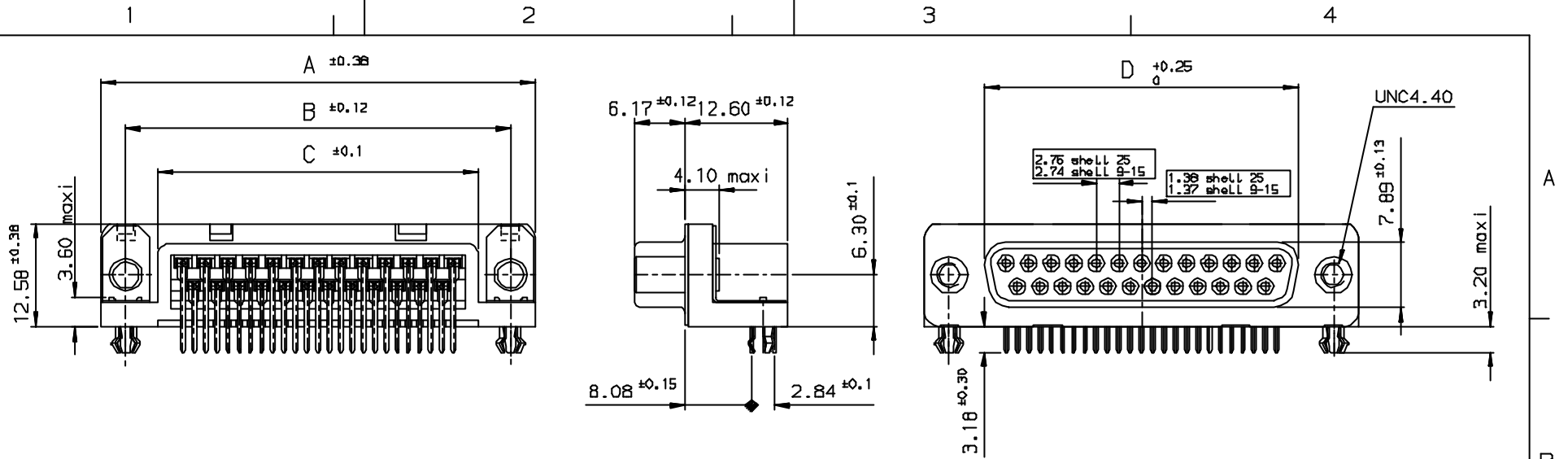

PC card drilling dimensions(after plating)
(thickness 1.60±0.20mm)

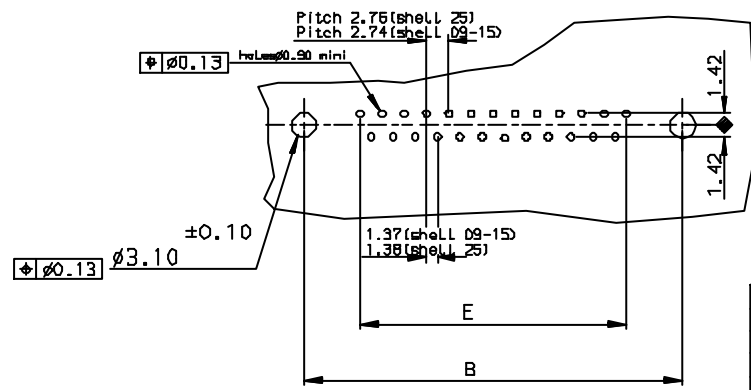

Pull Parts						PART NUMBER
SHELL	A±0.38	B±0.12	C±0.10	D±0.25	E±0.07	Gold Flash
09	30.81	24.99	16.96	16.21	10.96	D09S33E4GV00**
15	39.14	33.32	25.18	24.54	19.18	D15S33E4GV00**
25	53.03	47.04	39.12	38.25	33.12	D25S33E4GV00**

GENERAL CHARACTERISTICS, SEE DRAWING C01-8646-0000

LF FOR LEAD FREE

Utr	Eon no	Dr	date
•	105-0124	JS	27/7/05

Dr JOHN SLEEBA		7/4/93	Product Family	DELTA-D	Tolerance LINEAR ±0.1 ANGULAR ±1°	Projection	MM
Eng GEORGE W		7/4/93	Spec ref			Size	A3
Chr GEORGE W		27/7/05	Material			Scale	
Appr K Somasundaram		27/7/05				ECN	
FCI		Title SOCKET CONNECT.DELTA D right angle screwlock, harpoon & metal plate		Dwg no	C01-8646-0147		Rev.
Catalog no		DELTA-D		CUSTOMER COPY		Sheet 1 of 1	

INDEX	DATE	REVISION DESCRIPTION
•	27/7/05	LEAD FREE DETAILS ADDED