

# PN Series Alternate & Momentary Action Pushbutton Switches



A

Pushbutton

## Features/Benefits

- **Momentary or locking action**
- **Different actuation forces for customized feel**
- **Low cost, reliable contact design**
- **Single and double pole options**
- **RoHS compliant**

## Typical Applications

- **Computers and peripherals**
- **Instrumentation and measurement equipment**
- **Non-power, on-off switch applications**

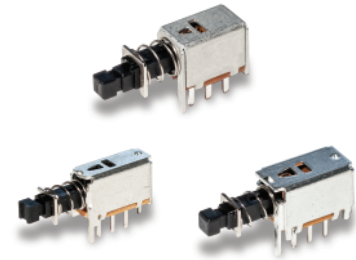

## Specifications

CONTACT RATING: 0.2 AMP @ 30 V DC max.  
 ELECTRICAL LIFE: 10,000 make-and-break cycles at full load.  
 MECHANICAL LIFE: 10,000 on/off cycles.  
 CONTACT RESISTANCE: 30 mΩ max. initial  
 INSULATION RESISTANCE: 100 MΩ min.  
 DIELECTRIC STRENGTH: 500 V AC min.  
 OPERATING/STORAGE TEMPERATURES: -10°C to 60°C.  
 PACKAGING: Switches are supplied in anti-static trays.

## Materials

FRAME: Tin plated steel.  
 ACTUATOR: PA 66 black.  
 BASE: Phenolic resin.  
 TERMINALS: Silver plated brass.  
 MOVABLE CONTACTS: Silver plated phosphor bronze.  
 RETURN SPRING: SWC  
 DETENT SPRING: Phosphor bronze.  
 DETENT SPRING PLATE: Phosphor bronze.  
 RETURN SPRING RETAINER RING: Nickel plated steel.  
 TERMINAL SEAL: Epoxy.

## Build-A-Switch

To order, simply select desired option from each category and place in the appropriate box. For additional options not shown in catalog, consult Customer Service Center.

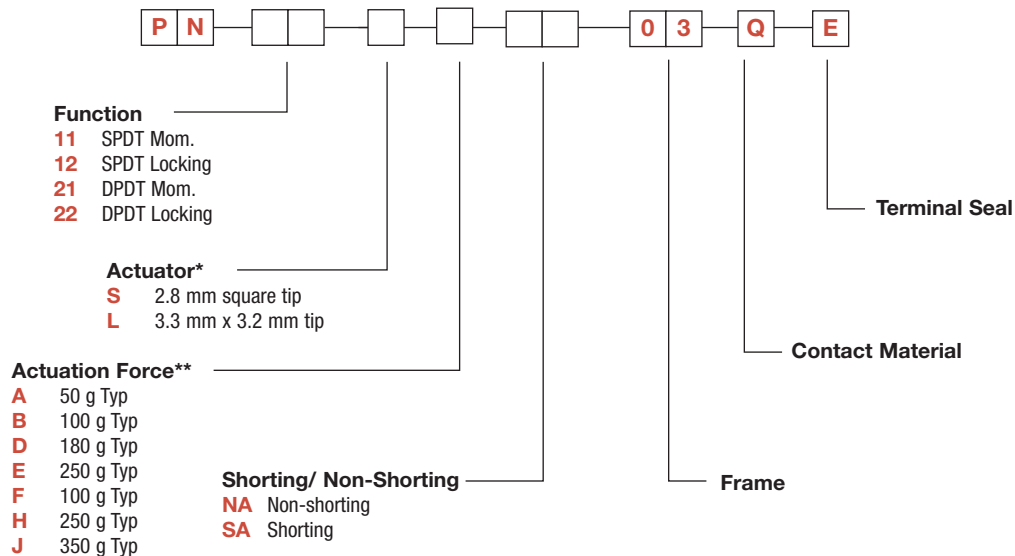

\* Note - The switch body style dimensions differ for each of these 3 groupings

"S" actuator available for PN 11 & PN 12 options

"S" actuator available for PN 21 & PN 22 options

"L" actuator available for PN 21 & PN 22 options

\*\* Actuation Force "A" only available with PN11 with "S" actuator

PN 11 & PN 21 available with Actuation Force "B", "D", "E", "F", "H", "J"

PN 12 & PN 22 available with Actuation Force "D", "E", "H", "J"

Full travel

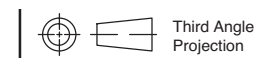

Specifications and dimensions subject to change



# PN Series Alternate & Momentary Action Pushbutton Switches

Pushbutton  
A

**PN 11** SPDT Mom.  
**PN 12** SPDT Locking

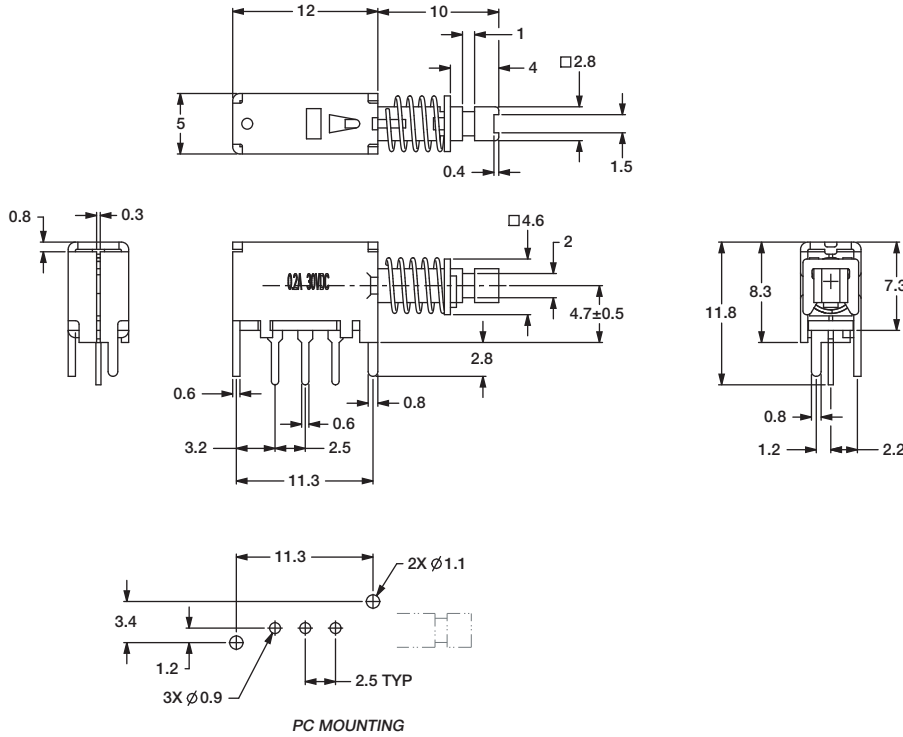

**PN 21** DPDT Mom. with "S" Actuator  
**PN 22** DPDT Locking with "S" Actuator

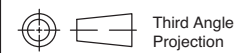
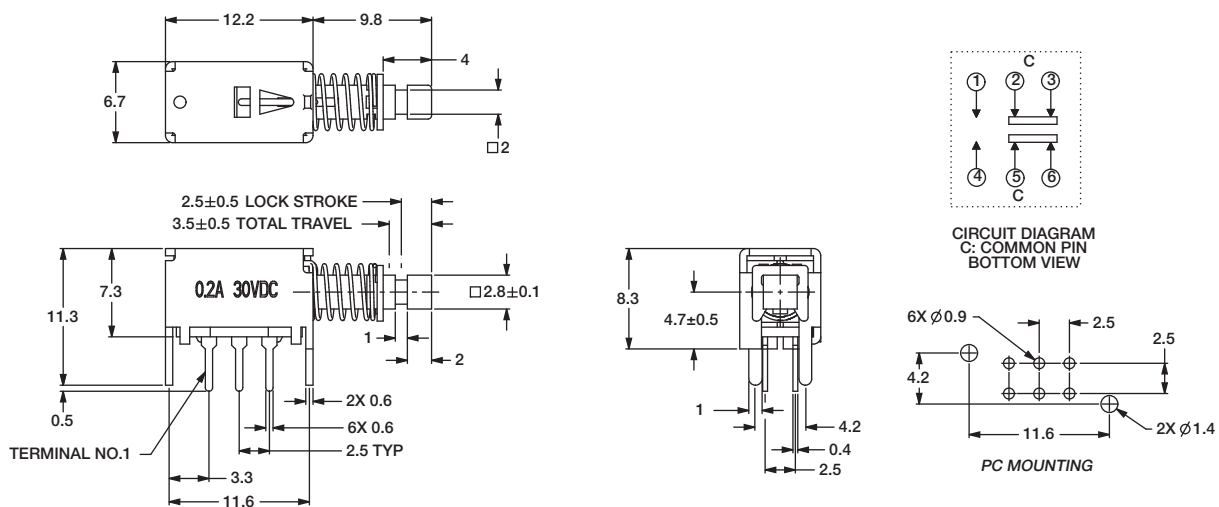

Dimensions are shown: mm  
Specifications and dimensions subject to change



# PN Series Alternate & Momentary Action Pushbutton Switches



A

Pushbutton

**PN 21** DPDT Mom. with "L" Actuator  
**PN 22** DPDT Locking with "L" Actuator

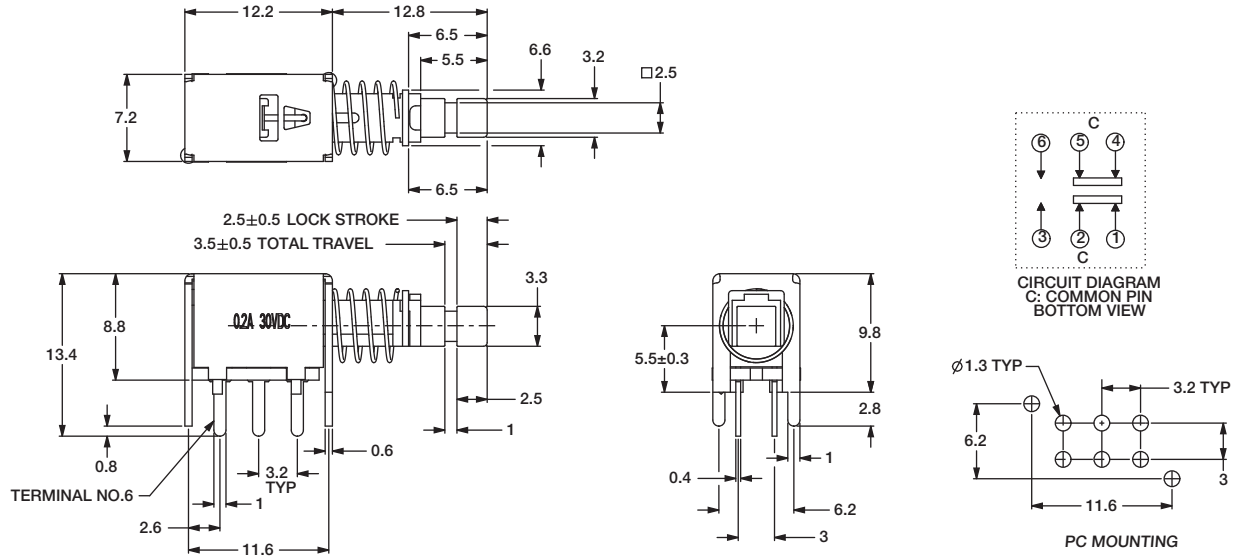

BUTTONS MUST BE ORDERED SEPARATELY. SHIPPED IN BULK.

**PE**

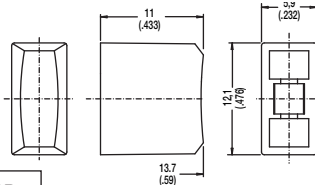
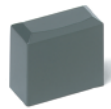

OPTION CODE	COLOR
<b>RD</b>	Red
<b>GY</b>	Gray
<b>BK</b>	Black
<b>WH</b>	White

PE and PV buttons fit "L" actuators

**PV**

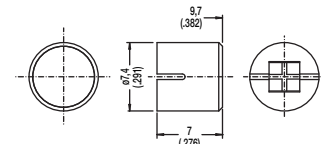

**Indexed**

**G001A** Black  
**G001G** Gray  
**G001I** Ivory  
**G001R** Red

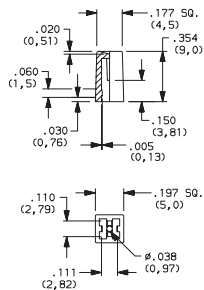
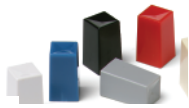

**Rectangular**

**G002A** Black  
**G002G** Gray  
**G002I** Ivory  
**G002R** Red

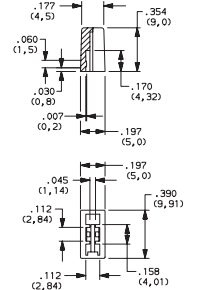

**Round**

**G003A** Black  
**G003G** Gray  
**G003I** Ivory  
**G003R** Red



G001, G002, G003 and G004 buttons fit "S" actuators

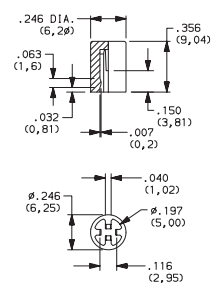

**Square**

**G004A** Black  
**G004G** Gray  
**G004I** Ivory  
**G004R** Red

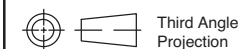
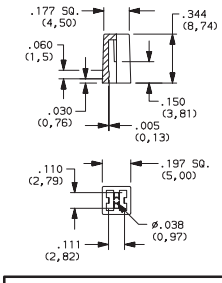

Dimensions are shown: Inches (mm)  
 Specifications and dimensions subject to change



www.ck-components.com