

Midget Fuse, 10.3 x 38 mm, 1000 VDC, Photovoltaic, gPV

new



Standard

PCB version

1000 VDC · gPV



Description

- Meets the new UL and IEC photovoltaic standards
- UL Recognized for 1000 VDC
- High breaking capacity of 20 kA @ 1000 VDC
- Low min. interrupting rating of 1.35 x In
- Meets the requirements of IEC 61730-2 for PV module safety

Standards

- IEC 60269-6
- UL 2579

Approvals

- VDE Certificate Number: 40033592
- UL File Number: E345791

Applications

- All photovoltaic applications
- Inverters
- Battery charge controllers
- In-line protection
- String fuses

References

Corresponding Fuseholder [FSO](#); [CSO](#); [231660](#)
Corresponding Cover [ESO 10.3x38](#)

Weblinks

[pdf-datasheet](#), [html-datasheet](#), [General Product Information](#), [Approvals](#), [CE declaration of conformity](#), [RoHS](#), [CHINA-RoHS](#), [REACH](#), [e-Shop](#), [SCHURTER-Stock-Check](#), [Distributor-Stock-Check](#), [Accessories](#), [Detailed request for product](#)

Technical Data

| | |
|------------------------------|--|
| Rated Voltage | 1000 VDC |
| Rated current | 1 - 30 A |
| Breaking Capacity | 20 kA |
| Characteristic | gPV |
| Mounting | Insert, PCB/THT |
| Admissible Ambient Air Temp. | -50 °C to 125 °C |
| Unit Weight | 8.3 g |
| Storage Conditions | 0 °C to 60 °C, max. 70% r.h. |
| Product Marking |  Type, Current, Rated voltage, Breaking Capacity, Characteristic, Approvals |

Dimension

Standard

10.3 mm

Panel cut-out for front mounting

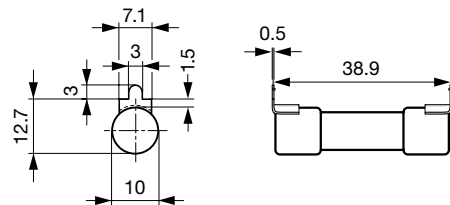
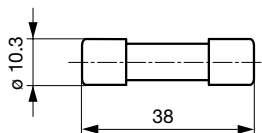

Derating Curves

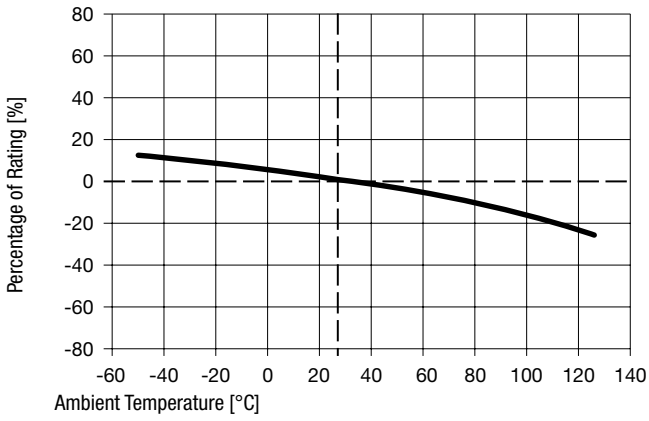

Pre-Arcing Time

Rated Current I_n 1.0 x I_n min. 1.13 x I_n min. 1.35 x I_n min. 1.45 x I_n max. 2.0 x I_n max.

| | | | | | |
|------------|--------|--------|--------|--------|-------|
| 1 A - 30 A | 60 min | 60 min | 60 min | 60 min | 4 min |
|------------|--------|--------|--------|--------|-------|

Time-Current-Curves

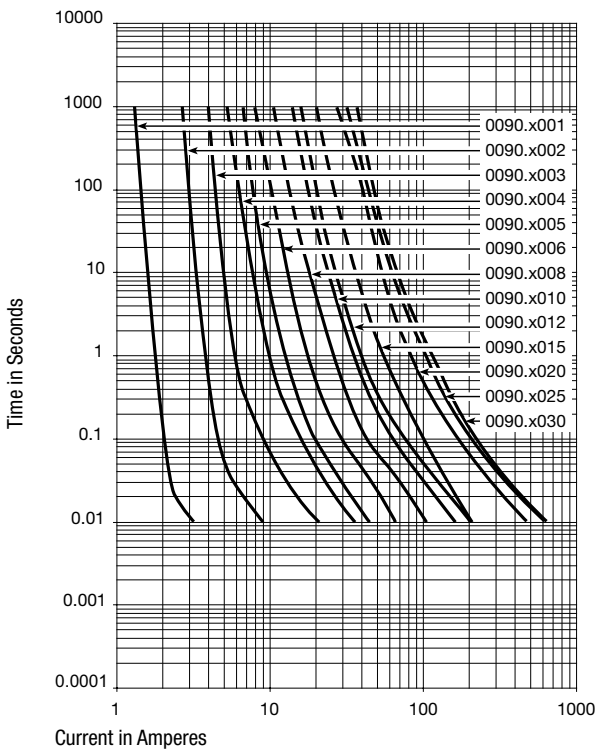

All Variants

| Rated Current [A] | Mounting | Rated Voltage [VDC] | Breaking Capacity | Power Dissipation 1.0 I _n typ. [mW] | Melting I ² t 20 kA typ. [A ² s] |  |  | Order Number |
|-------------------|----------|---------------------|-------------------|--|--|---|---|--------------|
| 1 | Standard | 1000 | 1) | 602 | 0.554 | ● | ● | 0090.0001 |
| 2 | Standard | 1000 | 1) | 1586 | 4.755 | ● | ● | 0090.0002 |
| 3 | Standard | 1000 | 1) | 1504 | 7.882 | ● | ● | 0090.0003 |
| 4 | Standard | 1000 | 1) | 1491 | 23.03 | ● | ● | 0090.0004 |
| 5 | Standard | 1000 | 1) | 1465 | 42.6 | ● | ● | 0090.0005 |
| 6 | Standard | 1000 | 1) | 1348 | 80.25 | ● | ● | 0090.0006 |
| 8 | Standard | 1000 | 1) | 1610 | 199 | ● | ● | 0090.0008 |
| 10 | Standard | 1000 | 1) | 1760 | 401 | ● | ● | 0090.0010 |
| 12 | Standard | 1000 | 1) | 1965 | 642 | ● | ● | 0090.0012 |
| 15 | Standard | 1000 | 1) | 1914 | 505 | ● | ● | 0090.0015 |
| 20 | Standard | 1000 | 1) | 2810 | 1313 | ● | ● | 0090.0020 |
| 25 | Standard | 1000 | 1) | 2981 | 2371 | ● | ● | 0090.0025 |
| 30 | Standard | 1000 | 1) | 3923 | 2679 | ● | ● | 0090.0030 |
| 1 | PCB | 1000 | 1) | 602 | 0.554 | ● | ● | 0090.1001 |
| 2 | PCB | 1000 | 1) | 1586 | 4.755 | ● | ● | 0090.1002 |
| 3 | PCB | 1000 | 1) | 1504 | 7.882 | ● | ● | 0090.1003 |
| 4 | PCB | 1000 | 1) | 1491 | 23.03 | ● | ● | 0090.1004 |
| 5 | PCB | 1000 | 1) | 1465 | 42.6 | ● | ● | 0090.1005 |
| 6 | PCB | 1000 | 1) | 1348 | 80.25 | ● | ● | 0090.1006 |
| 8 | PCB | 1000 | 1) | 1610 | 199 | ● | ● | 0090.1008 |
| 10 | PCB | 1000 | 1) | 1760 | 401 | ● | ● | 0090.1010 |
| 12 | PCB | 1000 | 1) | 1965 | 642 | ● | ● | 0090.1012 |
| 15 | PCB | 1000 | 1) | 2282 | 505 | ● | ● | 0090.1015 |
| 20 | PCB | 1000 | 1) | 2810 | 1313 | ● | ● | 0090.1020 |
| 25 | PCB | 1000 | 1) | 2981 | 2371 | ● | ● | 0090.1025 |
| 30 | PCB | 1000 | 1) | 3923 | 2679 | ● | ● | 0090.1030 |

Most Popular.

Availability for all products can be searched real-time: <http://www.schurter.com/en/Stock-Check/Stock-Check-SCHURTER>

1) 20 kA @ 1000 VDC, L/R < 2ms

| Packaging Unit | Standard version | Bulk (10 pcs.) |
|----------------|------------------|-----------------|
| | PCB version | Bulk (100 pcs.) |

Zubehör

Description



ESO 10.3x38
Fuse Inserter/Extractor with Cover Function for 10.3x38 mm Fuses in Clips, Patent Pending

Mouser Electronics

Authorized Distributor

Click to View Pricing, Inventory, Delivery & Lifecycle Information:

Schurter:

[0090.0001](#) [0090.0002](#) [0090.0003](#) [0090.0004](#) [0090.0005](#) [0090.0006](#) [0090.0008](#) [0090.0010](#) [0090.0012](#) [0090.0015](#)
[0090.0020](#) [0090.0025](#) [0090.0030](#) [0090.1001](#) [0090.1002](#) [0090.1003](#) [0090.1004](#) [0090.1005](#) [0090.1006](#) [0090.1008](#)
[0090.1010](#) [0090.1012](#) [0090.1015](#) [0090.1020](#) [0090.1025](#) [0090.1030](#)