

NO. OF CCTS	DIMN. "A"	DIMN. "B"
2	(5.08) .200	(2.54) .100
3	(7.62) .300	(5.08) .200
4	(10.16) .400	(7.62) .300
5	(12.70) .500	(10.16) .400
6	(15.24) .600	(12.70) .500
7	(17.78) .700	(15.24) .600
8	(20.32) .800	(17.78) .700
9	(22.86) .900	(20.32) .800
10	(25.40) 1.000	(22.86) .900
11	(27.94) 1.100	(25.40) 1.000
12	(30.48) 1.200	(27.94) 1.100
13	(33.02) 1.300	(30.48) 1.200
14	(35.56) 1.400	(33.02) 1.300
15	(38.10) 1.500	(35.56) 1.400
16	(40.64) 1.600	(38.10) 1.500
17	(43.18) 1.700	(40.64) 1.600
18	(45.72) 1.800	(43.18) 1.700
19	(48.26) 1.900	(45.72) 1.800
20	(50.80) 2.000	(48.26) 1.900
21	(53.34) 2.100	(50.80) 2.000
22	(55.88) 2.200	(53.34) 2.100
23	(58.42) 2.300	(55.88) 2.200
24	(60.96) 2.400	(58.42) 2.300
25	(63.50) 2.500	(60.96) 2.400
26	(66.04) 2.600	(63.50) 2.500
27	(68.58) 2.700	(66.04) 2.600
28	(71.12) 2.800	(68.58) 2.700

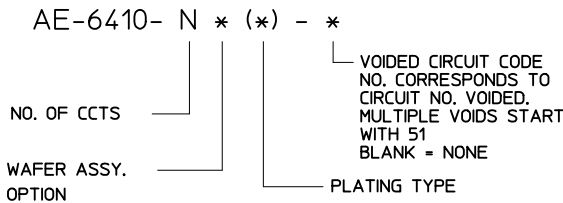

NOTES:

1. WAVER MATERIAL: NYLON, UL94V-0, PIN MATERIAL: BRASS
2. FINISH:
102 = OVERALL TIN: 0.00508/.000200 MIN. OVER 0.00254/.000100 MIN. COPPER
154 = OVERALL TIN: 0.00254/.00100 MIN. OVER 0.00127/.000050 MIN. NICKEL
501 = OVERALL GOLD: 0.00051/.000020 MIN. OVER 0.00076/.000030 MIN NICKEL
503 = OVERALL GOLD 0.00076/.000030 MIN. OVER 0.00127/.000050 MIN NICKEL
509 = OVERALL GOLD 0.00127/.000050 MIN. OVER 0.00076/.000030 MIN NICKEL
516 = OVERALL GOLD 0.00025/.000010 MIN. OVER 0.00076/.000030 MIN NICKEL
3. THIS PART CONFORMS TO MOLEX PROD. SPEC. PS-99020-0088.
4. PACKAGING: PER PK-6410-002
5. PIN SOLDERABILITY PER MOLEX SPEC. SMES-152.
6. SINGLE RAMP ON 2-6 CCTS TWO RAMPS ON 7-28 CCTS, AS SHOWN.
7. PIN PUSH OUT FORCE: (0.907 Kg)/2lbs MIN.
8. PCB THICKNESS 1.6MM
9. WAFERS STACKABLE END TO END WITH (2.54)/.100 BETWEEN END PINS
10. THIS PART CONFORMS TO CLASS B REQUIREMENTS OF COSMETIC SPECIFICATION PS-45499-002.
11. CIRCUIT 1 DESIGNATION IS USED TO DEFINE VOID LOCATION. CIRCUIT 1 MAY OR MAY NOT LINE UP WITH CIRCUIT 1 ON THE MATING HOUSING.

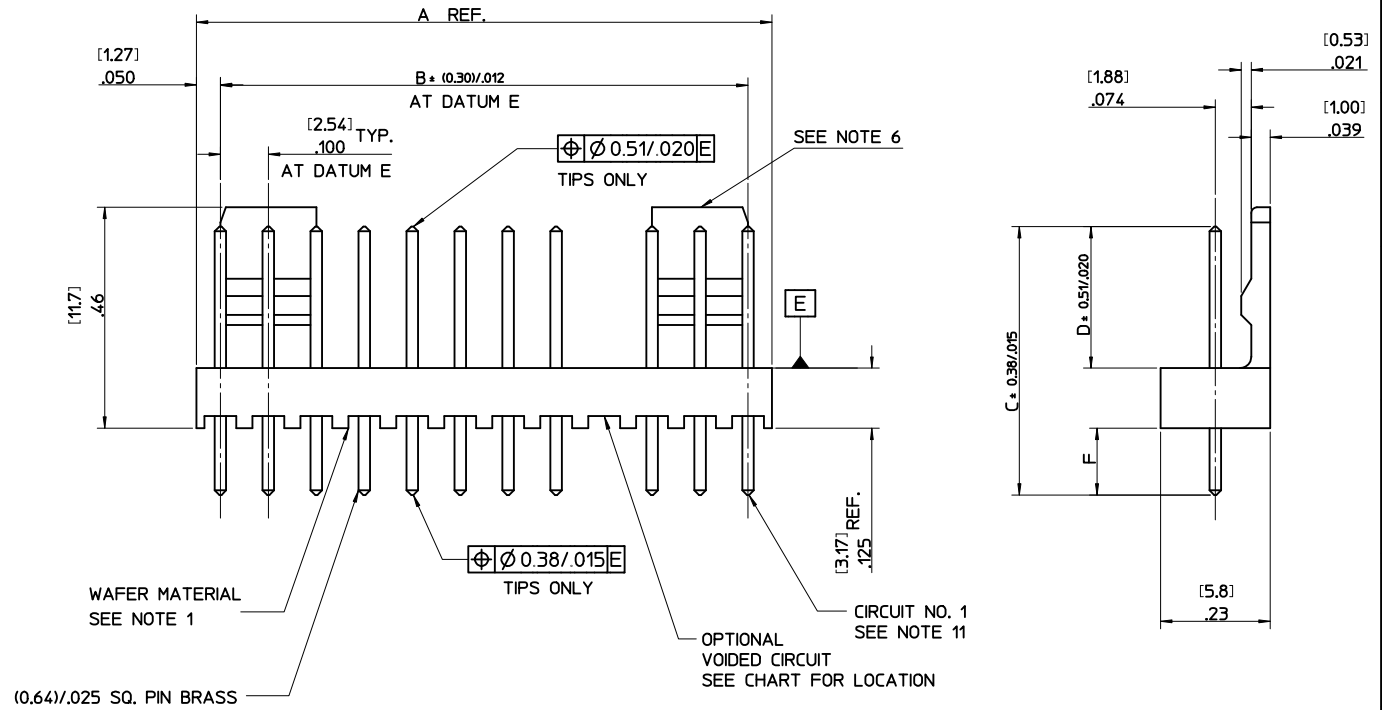
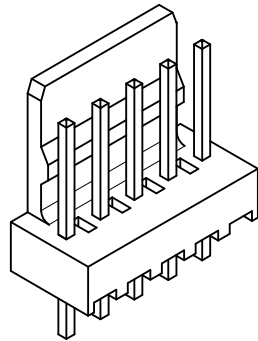
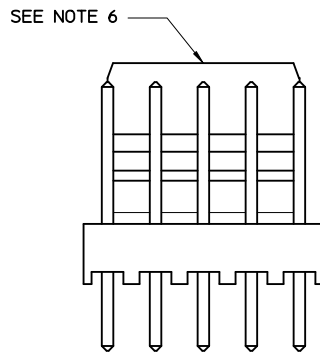
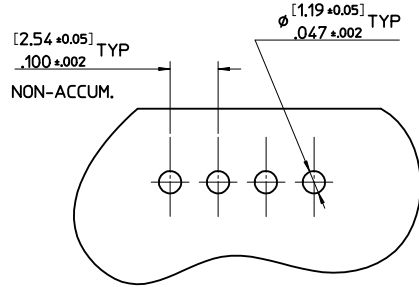

RECOMMENDED P.C.B. HOLE DIMENSIONS
(STANDARD SERIES)

CHANGE PK SPEC. DEC NO: UCP2011-3430 DRWN:KIPPER 2011/05/05 CHKD:ANDERSON 2011/05/05 APPR:FSMITH 2011/06/07	QUALITY SYMBOLS ▽=0 ▽=0 ▽=0	GENERAL TOLERANCES (UNLESS SPECIFIED)		DIMENSION STYLE		SCALE	DESIGN UNITS	THIRD ANGLE PROJECTION	
		mm	INCH	MM/IN		5:1	METRIC		
BB3	DESCRIPTION	4 PLACES ± --- ± ---		DRAWN BY	DATE	TITLE WAFER, FRICTION LOCK KK (2.54)/.100 FOR (0.64)/.025 SQ. PINS			
		3 PLACES ± --- ± .010		T. MAHON	28/01/03				
		2 PLACES ± 0.25 ± .014		CHECKED BY	DATE	MOLEX MOLEX INCORPORATED			
		1 PLACE ± 0.35 ± ---		BMAGUIRE	28/01/03				
		ANGULAR ± .5 °		APPROVED BY	DATE	DOCUMENT NO. SDAE-6410-N			
		DRAFT WHERE APPLICABLE MUST REMAIN WITHIN DIMENSIONS		JDENNEHY	2005/03/11				
		SEE CHART		MATERIAL NO.		SHEET NO. 1 OF 4			
		THIS DRAWING CONTAINS INFORMATION THAT IS PROPRIETARY TO MOLEX INCORPORATED AND SHOULD NOT BE USED WITHOUT WRITTEN PERMISSION		SIZE					

ENG. NO.	AE-6410-NA (102)	AE-6410-NC (102)	AE-6410-NH (102)	AE-6410-NJ (102)	AE-6410-NL (154)	AE-6410-NM (154)	
DIMN. "D"	(7.50 ±0.25) .295 ±0.10	(7.14 ±0.25) .281 ±0.10	(7.49 ±0.25) .295 ±0.10	(18.80 ±0.38) .740 ±0.15	(8.50 ±0.38) .335 ±0.15	(7.62 ±0.38) .300 ±0.15	
DIMN. "C"	(14.22) / .560	(20.32) / .800	(14.98) / .590	(25.40) / 1.000	(23.80) / .937	(20.32) / .800	
DIMN. "F"	(3.56) / .140 REF	(10.00) / .394 REF	(4.32) / .170 REF	(3.43) / .135 REF	(12.13) / .477 REF	(9.53) / .375 REF	
PLATING	102	102	102	102	154	154	
NO. OF CIRCUITS	2	AE-6410-2A(102) 22-27-2021	AE-6410-2C(102) 38-00-6292	AE-6410-2H(102) 38-00-6754	AE-6410-2J(102) NOT TOOLED	AE-6410-2L(154) NOT TOOLED	AE-6410-2M(154) NOT TOOLED
	3	3 A(102) 2031	3 C(102) 6293	3 H(102) NOT TOOLED	3 J(102) NOT TOOLED	3 L(154) 26-01-3195	3 M(154) 26-01-3179
	4	4 A(102) 2041	4 C(102) 6294	4 H(102) 22-27-2046	4 J(102) NOT TOOLED	4 L(154) NOT TOOLED	4 M(154) NOT TOOLED
	5	5 A(102) 2051	5 C(102) 6295	5 H(102) NOT TOOLED	5 J(102) 22-27-2057	5 L(154) ↑	5 M(154) ↑
	6	6 A(102) 2061	6 C(102) 6296	6 H(102) ↑	6 J(102) NOT TOOLED	6 L(154)	6 M(154)
	7	7 A(102) 2071	7 C(102) 6297	7 H(102)	7 J(102) NOT TOOLED	7 L(154)	7 M(154)
	8	8 A(102) 2081	8 C(102) 6298	8 H(102)	8 J(102) 22-27-2087	8 L(154)	8 M(154)
	9	9 A(102) 2091	9 C(102) 6299	9 H(102)	9 J(102) NOT TOOLED	9 L(154)	9 M(154)
	10	10 A(102) 2101	10 C(102) 6300	10 H(102) ↓	10 J(102) ↑	10 L(154)	10 M(154)
	11	11 A(102) 2111	11 C(102) 6301	11 H(102) NOT TOOLED	11 J(102)	11 L(154)	11 M(154)
	12	12 A(102) 2121	12 C(102) 6302	12 H(102) 22-27-2126	12 J(102)	12 L(154)	12 M(154)
	13	13 A(102) 2131	13 C(102) 6303	13 H(102) NOT TOOLED	13 J(102)	13 L(154) ↓	13 M(154)
	14	14 A(102) 2141	14 C(102) 6304	14 H(102) ↑	14 J(102)	14 L(154) NOT TOOLED	14 M(154)
	15	15 A(102) 2151	15 C(102) 6305	15 H(102)	15 J(102)	15 L(154) 38-00-1736	15 M(154)
	16	16 A(102) 2161	16 C(102) 6306	16 H(102)	16 J(102)	16 L(154) NOT TOOLED	16 M(154)
	17	17 A(102) 2171	17 C(102) 6307	17 H(102)	17 J(102)	17 L(154) ↑	17 M(154)
	18	18 A(102) 2181	18 C(102) 6308	18 H(102)	18 J(102)	18 L(154)	18 M(154)
	19	19 A(102) 2191	19 C(102) 6309	19 H(102) ↓	19 J(102)	19 L(154)	19 M(154)
	20	20 A(102) 2201	20 C(102) 38-00-6310	20 H(102)	20 J(102)	20 L(154)	20 M(154)
	21	21 A(102) 2211	21 C(102) NOT TOOLED	21 H(102)	21 J(102)	21 L(154)	21 M(154)
	22	22 A(102) 2221	22 C(102) ↑	22 H(102)	22 J(102)	22 L(154)	22 M(154)
	23	23 A(102) 2231	23 C(102) ↑	23 H(102)	23 J(102)	23 L(154)	23 M(154)
	24	24 A(102) 2241	24 C(102)	24 H(102)	24 J(102)	24 L(154)	24 M(154)
	25	25 A(102) 2251	25 C(102)	25 H(102)	25 J(102)	25 L(154)	25 M(154)
	26	26 A(102) 2261	26 C(102)	26 H(102)	26 J(102)	26 L(154)	26 M(154)
	27	27 A(102) 2271	27 C(102) ↓	27 H(102) ↓	27 J(102) ↓	27 L(154) ↓	27 M(154) ↓
	28	AE-6410-28A(102) 22-27-2281	AE-6410-28C(102) NOT TOOLED	AE-6410-28H(102) NOT TOOLED	AE-6410-28J(102) NOT TOOLED	AE-6410-28L(154) NOT TOOLED	AE-6410-28M(154) NOT TOOLED

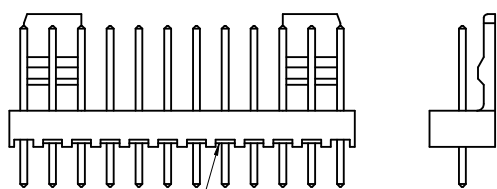

RIBS ADDED
(4-28 CCTS. ONLY)
ALTERNATIVE WAFER CONFIGURATION

UPDATE BORDER EC NO: UCP2011-3430 DRWN:KIPPER 2011/05/05 CHKD:BARBERSON 2011/05/05 APPR:FSMITH 2011/06/07	QUALITY SYMBOLS ▽=0 ▽=0 ▽=0	GENERAL TOLERANCES (UNLESS SPECIFIED) mm INCH 4 PLACES ± --- ± --- 3 PLACES ± --- ± .010 2 PLACES ± 0.25 ± .014 1 PLACE ± 0.35 ± --- ANGULAR ± .5 °	DIMENSION STYLE MM/IN DRAWN BY DATE T. MAHON 28/01/03 CHECKED BY DATE BMAGUIRE 28/01/03 APPROVED BY DATE JDENNEY 2005/03/11	SCALE 4:1 DESIGN UNITS METRIC THIRD ANGLE PROJECTION	TITLE WAFER, FRICTION LOCK KK (2.54)/.100 FOR (0.64)/.025 SQ. PINS
		DRAFT WHERE APPLICABLE MUST REMAIN WITHIN DIMENSIONS	MATERIAL NO. SEE CHART SIZE C	DOCUMENT NO. SDAE-6410-N SHEET NO. 2 OF 4	

ENG. NO.	AE-6410-NA (501)		AE-6410-NA (516)		AE-6410-NK (516)		AE-6410-NC (501)		AE-6410-NA (509)		AE-6410-NS (501)		AE-6410-NA (503)		
DIMN. "D"	(7.50 ±0.25) .295 ±.010		(7.50 ±0.25) .295 ±.010		(9.22) REF .363		(7.14 ±0.25) .281 ±.010		(7.50 ±0.25) .295 ±.010		(7.50 ±0.25) .295 ±.010		(7.50 ±0.25) .295 ±.010		
DIMN. "C"	(14.22) / .560		(14.22) / .560		(15.88) / .625		(20.32) / .800		(14.22) / .560		(16.51) / .649		(14.22) / .560		
DIMN. "F"	(3.56) / .140 REF		(3.56) / .140 REF		(3.48 ±0.25) .137 ±.010		(10.00) / .394 REF		(3.56) / .140 REF		(5.84) / .230 REF		(3.56) / .140 REF		
PLATING	501		516		516		501		509		501		503		
NO. OF CIRCUITS	2	AE-6410-2A(501)	22-29-2021	AE-6410-2A(516)	22-29-2022	AE-6410-2K(516)	38-00-0932	AE-6410-2C(501)	NOT TOOLED	AE-6410-2A(509)	38-00-7250		NOT TOOLED	AE-6410-2A(503)	38-00-7062
	3	3 A(501)	↑ 2031	3 A(516)	↑ 2032	3 K(516)	↑ 0933	3 C(501)	38-00-5909	3 A(509)	NOT TOOLED		NOT TOOLED	3 A(503)	↑ 7063
	4	4 A(501)	2041	4 A(516)	2042	4 K(516)	0934	4 C(501)	NOT TOOLED	4 A(509)	38-00-7251	AE-6410-4S(501)	38-00-7666	4 A	↑ 7064
	5	5 A(501)	2051	5 A(516)	2052	5 K(516)	0935	5 C(501)		5 A(509)	NOT TOOLED		NOT TOOLED	5 A	↑ 7065
	6	6 A(501)	2061	6 A(516)	2062	6 K(516)	0936	6 C(501)		6 A(509)		6 S(501)	38-00-7667	6 A	↑ 7066
	7	7 A(501)	2071	7 A(516)	2072	7 K(516)	0937	7 C(501)		7 A(509)			NOT TOOLED	7 A	↓ 7067
	8	8 A(501)	2081	8 A(516)	2082	8 K(516)	0938	8 C(501)		8 A(509)				8 A	↑ 38-00-7068
	9	9 A(501)	2091	9 A(516)	2092	9 K(516)	0939	9 C(501)		9 A(509)				9 A	↑ NOT TOOLED
	10	10 A(501)	2101	10 A(516)	2102	10 K(516)	0940	10 C(501)		10 A(509)				10 A	↑ NOT TOOLED
	11	11 A(501)	2111	11 A(516)	2112	11 K(516)	0941	11 C(501)		11 A(509)				11 A	↑ NOT TOOLED
	12	12 A(501)	2121	12 A(516)	2122	12 K(516)	0942	12 C(501)		12 A(509)				12 A	↑ 38-00-7072
	13	13 A(501)	2131	13 A(516)	2132	13 K(516)	0943	13 C(501)		13 A(509)				13 A	↑ NOT TOOLED
	14	14 A(501)	2141	14 A(516)	2142	14 K(516)	0944	14 C(501)		14 A(509)				14 A	↑ 38-00-7074
	15	15 A(501)	2151	15 A(516)	2152	15 K(516)	0945	15 C(501)		15 A(509)				15 A	↑ NOT TOOLED
	16	16 A(501)	2161	16 A(516)	2162	16 K(516)	0946	16 C(501)		16 A(509)				16 A	↑
	17	17 A(501)	2171	17 A(516)	2172	17 K(516)	0947	17 C(501)		17 A(509)				17 A	↑
	18	18 A(501)	2181	18 A(516)	2182	18 K(516)	0948	18 C(501)		18 A(509)				18 A	↓
	19	19 A(501)	2191	19 A(516)	2192	19 K(516)	0949	19 C(501)		19 A(509)				19 A	↑ NOT TOOLED
	20	20 A(501)	2201	20 A(516)	2202	20 K(516)	0950	20 C(501)		20 A(509)				20 A	↑ 38-00-7080
	21	21 A(501)	2211	21 A(516)	2212	21 K(516)	0951	21 C(501)		21 A(509)				21 A	↑ NOT TOOLED
	22	22 A(501)	2221	22 A(516)	2222	22 K(516)	0952	22 C(501)		22 A(509)				22 A	↑ NOT TOOLED
	23	23 A(501)	2231	23 A(516)	2232	23 K(516)	0953	23 C(501)		23 A(509)				23 A	↑ NOT TOOLED
	24	24 A(501)	2241	24 A(516)	2242	24 K(516)	0954	24 C(501)		24 A(509)				24 A	↑ 38-00-0441
	25	25 A(501)	2251	25 A(516)	2252	25 K(516)	0955	25 C(501)		25 A(509)				25 A	↑ NOT TOOLED
	26	26 A(501)	2261	26 A(516)	2262	26 K(516)	0956	26 C(501)		26 A(509)				26 A	↓
	27	27 A(501)	↓ 2271	27 A(516)	↓ 2272	27 K(516)	↓ 0957	27 C(501)	↓	27 A(509)	↓		↓	27 A(503)	↓
	28	AE-6410-28A(501)	22-29-2281	AE-6410-28A(516)	22-29-2282	AE-6410-28K(516)	38-00-0958	AE-6410-28C(501)	NOT TOOLED	AE-6410-28A(509)	NOT TOOLED		NOT TOOLED	AE-6410-28A(503)	NOT TOOLED

UPDATE BORDER DEC NO: UCP2011-3430 DRWN:MKIPPER 2011/05/05 CHKD:BARBERSON 2011/05/05 APPR:FSMITH 2011/06/07	DESCRIPTION REV: BB3	QUALITY SYMBOLS	GENERAL TOLERANCES (UNLESS SPECIFIED)	DIMENSION STYLE	SCALE	DESIGN UNITS	THIRD ANGLE PROJECTION	
		▽=0	mm INCH	MM/IN	4:1	METRIC	T. MAHON 28/01/03 BMAGUIRE 28/01/03 JDENNEHY 2005/03/11	WAFER, FRICTION LOCK KK (2.54)/.100 FOR (0.64)/.025 SQ. PINS
		▽=0	4 PLACES ± --- ± --- 3 PLACES ± --- ± .010 2 PLACES ± 0.25 ± .014 1 PLACE ± 0.35 ± ---	DRAWN BY DATE CHECKED BY DATE APPROVED BY DATE	MATERIAL NO.	DOCUMENT NO.		
		▽=0	ANGULAR ± .5 °	SEE CHART	SHEET NO. 3 OF 4			
DRAFT WHERE APPLICABLE MUST REMAIN WITHIN DIMENSIONS			THIS DRAWING CONTAINS INFORMATION THAT IS PROPRIETARY TO MOLEX INCORPORATED AND SHOULD NOT BE USED WITHOUT WRITTEN PERMISSION					

VOIDED CIRCUIT OPTION

PART No.	ENG No.	CKT SIZE	VOID LOCATION	DIM D	DIM F (REF)	PLATING
38-00-7222	AE-6410-3A(102)-2	3	2	(7.50)/.295	(3.56)/.140	102
38-00-4749	-4A(102)-3	4	3	(7.50)/.295	(3.56)/.140	102
38-00-0611	-5A(102)-3	5	3	(7.50)/.295	(3.56)/.140	102
38-00-0089	-6A(102)-3	6	3	(7.50)/.295	(3.56)/.140	102
38-00-0090	-6A(102)-51	6	3,4,5	(7.50)/.295	(3.56)/.140	102
38-00-5370	-15A(102)-02	15	2	(7.50)/.295	(3.56)/.140	102
38-00-5371	-19A(102)-12	19	12	(7.50)/.295	(3.56)/.140	102
38-00-7688	-12A(102)-09	12	9	(7.50)/.295	(3.56)/.140	102

UPDATE BORDER EC NO: UCP2011-3430 DR: WNKIPPER 2011/05/05 CHKD: SANDERSON 2011/05/05 APPR: FSMITH 2011/06/07	QUALITY SYMBOLS ▽/0 ▽/0 ▽/0	GENERAL TOLERANCES (UNLESS SPECIFIED) <table border="1" style="width: 100%; border-collapse: collapse;"> <thead> <tr> <th></th> <th>mm</th> <th>INCH</th> </tr> </thead> <tbody> <tr> <td>4 PLACES</td> <td>± ---</td> <td>± ---</td> </tr> <tr> <td>3 PLACES</td> <td>± ---</td> <td>± .010</td> </tr> <tr> <td>2 PLACES</td> <td>± 0.25</td> <td>± .014</td> </tr> <tr> <td>1 PLACE</td> <td>± 0.35</td> <td>± ---</td> </tr> </tbody> </table> ANGULAR ± .5 °		mm	INCH	4 PLACES	± ---	± ---	3 PLACES	± ---	± .010	2 PLACES	± 0.25	± .014	1 PLACE	± 0.35	± ---	DIMENSION STYLE MM/IN DRAWN BY DATE T. MAHON 28/01/03 CHECKED BY DATE BMAGUIRE 28/01/03 APPROVED BY DATE JDENNEHY 2005/03/11 MATERIAL NO.	SCALE 4:1	DESIGN UNITS METRIC	THIRD ANGLE PROJECTION 	TITLE WAFER, FRICTION LOCK KK (2.54)/.100 FOR (0.64)/.025 SQ. PINS
		mm	INCH																			
	4 PLACES	± ---	± ---																			
	3 PLACES	± ---	± .010																			
2 PLACES	± 0.25	± .014																				
1 PLACE	± 0.35	± ---																				
DRAFT WHERE APPLICABLE MUST REMAIN WITHIN DIMENSIONS	SEE CHART	MOLEX INCORPORATED	DOCUMENT NO. SDAE-6410-N	SHEET NO. 4 OF 4																		
SIZE B	THIS DRAWING CONTAINS INFORMATION THAT IS PROPRIETARY TO MOLEX INCORPORATED AND SHOULD NOT BE USED WITHOUT WRITTEN PERMISSION																					
BB3																						