

ALL RIGHTS RESERVED. NO PORTION OF THIS PUBLICATION, WHETHER IN WHOLE OR IN PART CAN BE REPRODUCED WITHOUT THE EXPRESS WRITTEN CONSENT OF SPC TECHNOLOGY.

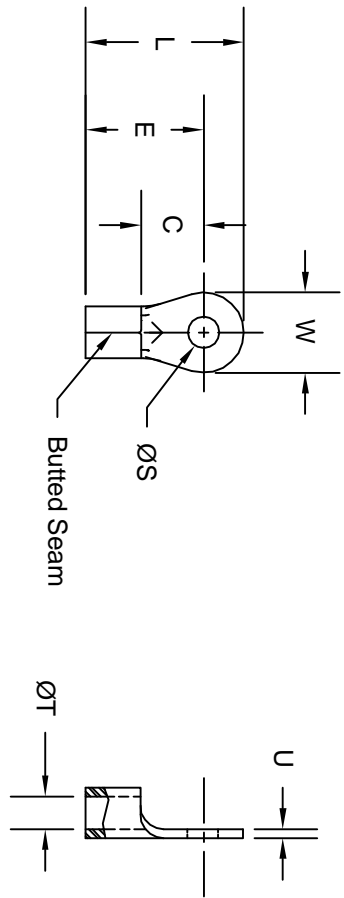

REVISIONS		DOC. NO. SPC-F005	* Effective: 12/21/98	* DCP No: 680				
DCP #	REV	DESCRIPTION	DRAWN	DATE	CHECKD	DATE	APPRVD	DATE
	A	Redrawn in AutoCad	JAP	11/18/91				
963	B	Added Bulk Items, was CRS-TO-****	JWM	8/21/01	JC	9/4/01	JC	9/4/01

SPC Type No.	Wire Size (AWG)	Stud Size	L	W	E	C	S	T	U	Pkg QTY
CRS-TO-1006-HT	12 ~ 10	6	.73	.38	.54	.29	.148	.135	.040	50
SPC3806	12 ~ 10	6	.73	.38	.54	.29	.148	.135	.040	500
CRS-TO-1010-HT	12 ~ 10	10	.73	.38	.54	.29	.196	.135	.040	50
SPC3807	12 ~ 10	10	.73	.38	.54	.29	.196	.135	.040	500
CRS-TO-1025-HT	12 ~ 10	1/4	.99	.61	.69	.44	.264	.135	.040	50
SPC3808	12 ~ 10	1/4	.99	.61	.69	.44	.264	.135	.040	500
CRS-TO-1406-HT	16 ~ 14	6	.60	.25	.47	.22	.148	.090	.030	100
SPC3809	16 ~ 14	6	.60	.25	.47	.22	.148	.090	.030	1000
CRS-HT-1410-HT	16 ~ 14	10	.70	.33	.54	.29	.200	.090	.030	100
SPC3804	16 ~ 14	10	.70	.33	.54	.29	.200	.090	.030	1000
CRS-TO-1425-HT	16 ~ 14	1/4	.93	.56	.65	.40	.265	.090	.030	100
SPC3805	16 ~ 14	1/4	.93	.56	.65	.40	.265	.090	.030	1000
CRS-TO-1806-HT	22 ~ 18	6	.60	.25	.47	.22	.148	.070	.030	100
SPC3801	22 ~ 18	6	.60	.25	.47	.22	.148	.070	.030	1000
CRS-TO-1810-HT	22 ~ 18	10	.70	.33	.54	.29	.200	.070	.030	100
SPC3802	22 ~ 18	10	.70	.33	.54	.29	.200	.070	.030	1000

NOTES:

1. MATERIAL: ALLOY STEEL, NICKEL PLATING.
2. TO BE FREE OF BURRS.
3. VOLTAGE RATING: 600 V
4. CONTINUOUS OPERATING TEMPERATURE: 900°F (482°C)
INTERMITTENT OPERATING TEMPERATURE: 1200°F (649°C)

DISCLAIMER:
ALL STATEMENTS AND TECHNICAL INFORMATION CONTAINED HEREIN ARE BASED UPON INFORMATION AND/OR TESTS WE BELIEVE TO BE ACCURATE AND RELIABLE SINCE CONDITIONS OF USE ARE BEYOND OUR CONTROL. THE USER SHALL DETERMINE THE FITNESS FOR THE PARTICULAR INTENDED USE AND ASSUME ALL RISK AND LIABILITY WHATSOEVER IN CONNECTION THEREWITH.



SPC TECHNOLOGY

Tolerances Unless Otherwise Specified
 .X = ±.015
 .XX = ±.010
 .XXX = ±.005

DRAWING TITLE: High Temperature Ring Terminals
SIZE: A
DWG. NO.: TA-333
ELECTRONIC FILE: TA-333
SCALE: NTS
U.O.M.: INCHES [mm]
SHEET: 1 OF 1